

REV.	DATE	DESCRIPTION
A	08/25/04	MODIFY COUPLING NUT PLATING

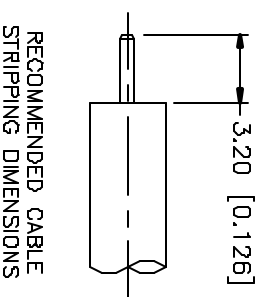
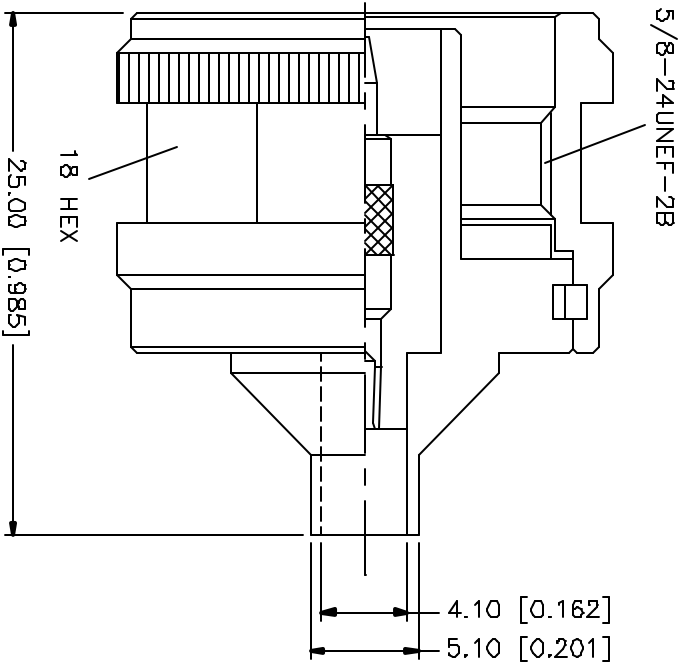

QTY	DESCRIPTION	MATERIAL	FINISH	QTY	UNLESS OTHERWISE SPECIFIED DIMENSIONS ARE IN INCHES AND FOR DIMENSIONS REFER TO THE DATA SHEET	UNLESS OTHERWISE SPECIFIED DIMENSIONS ARE IN MILLIMETERS AND FOR DIMENSIONS REFER TO THE DATA SHEET	APPROVALS	DATE	PART DESCRIPTION	DWG. NO.	REV.	SIZE	SCALE
1	COUPLING NUT	BRASS	NICKDOTE	1	0.5 - 0.6mm ± 0.20mm	0.5 - 0.6mm ± 0.20mm	G.R.S.	08/25/04	N DIRECT SOLDER PLUG (FOR .141" SEMI RIGID CABLE)	172133-11	A	A	NA
1	GASKET	SILICONE	RED	1	8 - 30mm ± 0.40mm	8 - 30mm ± 0.40mm							
1	CONTACT PIN	PHOS. BRONZE	GOLD	1	30 - 120mm ± 0.50mm	30 - 120mm ± 0.50mm							
1	INSULATOR	TEFLON	NATURAL	1	0.20 - .315 ± 0.007	0.20 - .315 ± 0.007							
1	BODY	BRASS	GOLD	1	.315 - 1.180 ± 0.015	.315 - 1.180 ± 0.015							
	DESCRIPTION	MATERIAL	FINISH	QTY	1.180 - 4.724 ± ± 0.020	1.180 - 4.724 ± ± 0.020	DO NOT SCALE DRAWING						

**Amphenol Connex**