

THIS DRAWING IS UNPUBLISHED.
 © COPYRIGHT BY TYCO ELECTRONICS CORPORATION. ALL RIGHTS RESERVED.

4

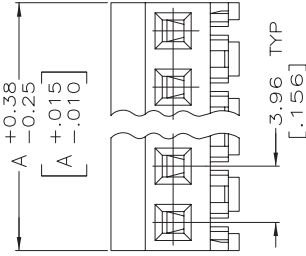
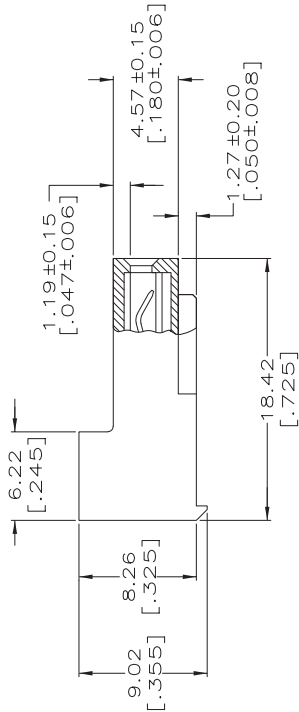
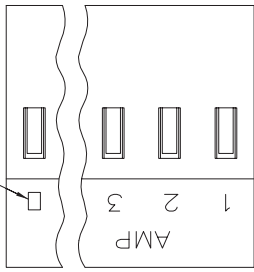

1

MATERIAL:
 CONNECTOR - NYLON UL94V-2 (ORANGE).
 CONTACTS - 0.30[.012] THICK COPPER ALLOY.
 PLATING - 0.00038[.000015] GOLD IN CONTACT AREA.
 0.00203[.000080] MIN THICKNESS BRIGHT TIN LEAD IN
 SLOT AREA FOR 641153-2 THRU 2-641153-4 OR
 MATTE WHISKER MITIGATED TIN IN SLOT AREA FOR
 3-641153-2 THRU 5-641153-4 OVER NICKEL
 UNDERPLATE.

2. CONTACTS ACCEPT 18 AWG WIRE WITH 2.41[.095] MAX INSULATION DIAMETER.
3. CONTACTS MUST ACCEPT 1.14±0.03[.045±.001] SQUARE POST AND REMAIN LOCKED IN POSITION.
4. IDENTIFICATION NUMBER FOR LAST CIRCUIT MAY NOT APPEAR ON ALL ASSEMBLIES.
5. DIMENSIONS IN BRACKETS ARE IN INCHES.
6. HOUSING FEATURES ARE: CLOSED END WITHOUT LOCKING RAMP.

NOTE DELETED.

NOTE DELETED.

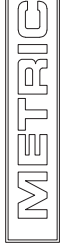

LOC CM O

DIST O

REVISONS
 P LTR L ECO-07-012878
 DATE 20JUN07
 DWN KWB
 APND DB

D

C

B

A

FINISH	NO. OF CIRCUITS	PART NO.
TIN	24	5-641153-4
TIN	23	5-641153-3
TIN	22	5-641153-2
TIN	21	5-641153-1
TIN	20	5-641153-0
TIN	19	4-641153-9
TIN	18	4-641153-8
TIN	17	4-641153-7
TIN	16	4-641153-6
TIN	15	4-641153-5
TIN	14	4-641153-4
TIN	13	4-641153-3
TIN	12	4-641153-2
TIN	11	4-641153-1
TIN	10	4-641153-0
TIN	9	3-641153-9
TIN	8	3-641153-8
TIN	7	3-641153-7
TIN	6	3-641153-6
TIN	5	3-641153-5
TIN	4	3-641153-4
TIN	3	3-641153-3
TIN	2	3-641153-2
TIN	24	2-641153-4
TIN	23	2-641153-3
TIN	22	2-641153-2
TIN	21	2-641153-1
TIN	20	2-641153-0
TIN	19	1-641153-9
TIN	18	1-641153-8
TIN	17	1-641153-7
TIN	16	1-641153-6
TIN	15	1-641153-5
TIN	14	1-641153-4
TIN	13	1-641153-3
TIN	12	1-641153-2
TIN	11	1-641153-1
TIN	10	1-641153-0
TIN	9	641153-9
TIN	8	641153-8
TIN	7	641153-7
TIN	6	641153-6
TIN	5	641153-5
TIN	4	641153-4
TIN	3	641153-3
TIN	2	641153-2

THIS DRAWING IS A CONTROLLED DOCUMENT.		DWN B. LEWIS 2-12-91	
DIMENSIONS: mm [INCHES]		2-12-91	
TOLERANCES UNLESS OTHERWISE SPECIFIED:		TYCO ELECTRONICS	
0 P/LC ±	PRODUCT SPEC	Tyco Electronics Corporation	
1 P/LC ±	108-1051	Harrisburg, Pa 17105-3608	
2 P/LC ±	APPLICATION SPEC	NAME	
3 P/LC ±	0.13 [0.05]	MTA-156 CONNECTOR ASSEMBLY,	
ANGLES ±	114-1020	18 AWG, STANDARD	
FINISH ±	WEIGHT	SIZE GAGE CODE DRAWING NO	
MATERIAL - Δ	CUSTOMER DRAWING	A2 00779 C-641153	
SCALE 4:1		SHEET 1 OF 1	
RESTRICTED TO		REV	