

47.5	49.7	22 03 1201	3022 20A	20
45	47.2	1191	19A	19
42.5	44.7	1181	18A	18
40	42.2	1171	17A	17
37.5	39.7	1161	16A	16
35	37.2	1151	15A	15
32.5	34.7	1141	14A	14
30	32.2	1131	13A	13
27.5	29.7	1121	12A	12
25	27.2	1111	11A	11
22.5	24.7	1101	10A	10
20	22.2	1091	09A	9
17.5	19.7	1081	08A	8
15	17.2	1071	07A	7
12.5	14.7	1061	06A	6
10	12.2	1051	05A	5
7.5	9.7	1041	04A	4
5	7.2	22 03 1031	3022 03A	3
A	(B)	POLYBAG PACKAGE オーダー番号 ORDER NO.	MODEL NO.	極数 CKT.

NOTES:

1. 材料 MATERIAL
 ウェハー: ポリアミド、UL94V-0 色: ナチュラル(白)
 WAFER: POLYAMIDE, UL94V-0 COLOR: NATURAL(WHITE)
 ピン: 黄銅、銅下地メッキ
 PIN: BRASS, TIN OVER COPPER PLATING
2. ウェハーのソリは、長さ 25.4mm に対して 0.2mm MAX.
 CAMBER MUST BE WITHIN 0.2mm MAX. PER 25.4mm
3. () 内寸法は参考値
 () REFERENCE DIMENSIONS
4. ELV 及び RoHS 適合品
 ELV AND RoHS COMPLIANT

REVISED EC NO: J2014-0294 DRW:SSAT002 2013/08/14 CHKD:KASAKAWA 2013/08/14 APPR:NUKITA 2013/08/19	DESCRIPTION REV	GENERAL TOLERANCES (UNLESS SPECIFIED)		DIMENSION STYLE MM ONLY		SCALE 4:1		DESIGN UNITS METRIC		THIRD ANGLE PROJECTION		
		10 UNDER	±0.2	DRAWN BY KAWASHIO	DATE 2012/01/21	TITLE WAFER ASSY KK 2.5MM						
		10 OVER 30 UNDER	±0.25	CHECKED BY KASAKAWA	DATE 2013/08/13							
		30 OVER	±0.3	APPROVED BY NUKITA	DATE 2013/08/13							
ANGULAR ±3 °		DRAFT WHERE APPLICABLE MUST REMAIN WITHIN DIMENSIONS		MATERIAL NO. SEE CHART		DOCUMENT NO. SD-3022-001		SHEET NO. 1 OF 1				
THIS DRAWING CONTAINS INFORMATION THAT IS PROPRIETARY TO MOLEX INCORPORATED AND SHOULD NOT BE USED WITHOUT WRITTEN PERMISSION												

10

9

8

7

6

5

4

3

2

1

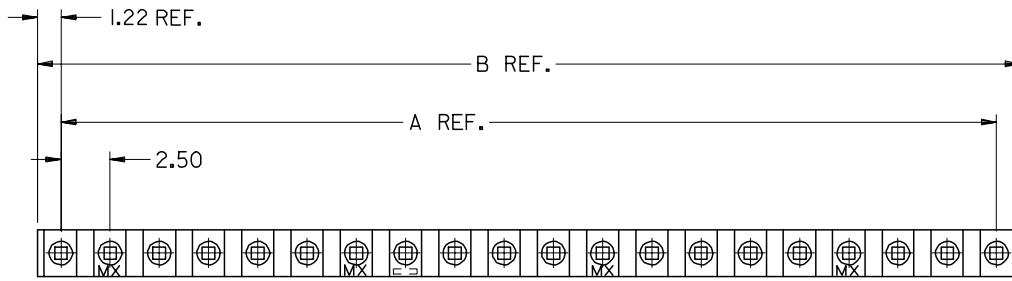

⊕ ∅ 0.51 C

SEE NOTE #1

NOTE 5

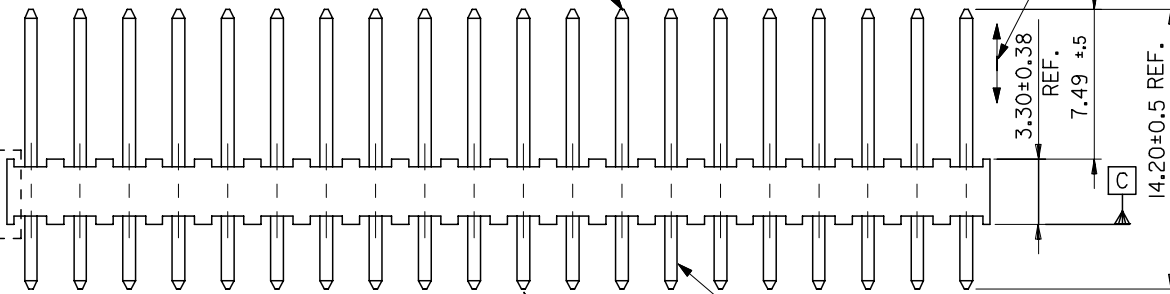

(0.64) SQ PIN, BRASS
.0076/.0051 TIN OVER .0028/.0025

⊕ ∅ 0.38 C

STACKABLE
ON 2.45 GRID

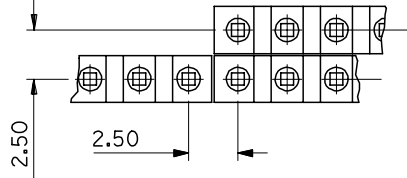

2.50

2.50

2.50 ±0.05 NON-ACCUM.

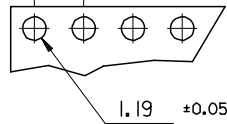

1.19 ±0.05 ∅ HOLES TYP.

RECOMMENDED P.C. BOARD
HOLE DIMENSIONS

NOTES :

- PIN PUSH OUT FORCE: 2 LBS. MIN.
- PIN SOLDERABILITY PER MOLEX ENG. STD. No. 152
- DIMENSIONS SHOWN ARE MILLIMETERS.
- CODE LETTER PRECEDING PART No. DESIGNATES MANUFACTURING LOCATION. I = IRELAND
- STEP ON ALL OCT SIZES
MXI: STEP ON 2 CCT SIZE ONLY

MAT'L: NYLON BASFKR4205 PER ES-I28B.

NOT TOOLED	AE-3022-25A	25	60.0	62.4
22-03-1221	AE-3022-22A	22	52.5	54.9
22-03-1211	21A	21	50.0	52.4
22-03-1201	20A	20	47.5	49.9
-1191	19A	19	45.0	47.4
-1181	18A	18	42.5	44.9
-1171	17A	17	40.0	42.4
-1161	16A	16	37.5	39.9
-1151	15A	15	35.0	37.4
-1141	14A	14	32.5	34.9
-1131	13A	13	30.0	32.4
-1121	12A	12	27.5	29.9
-1111	11A	11	25.0	27.4
-1101	10A	10	22.5	24.9
-1091	9A	9	20.0	22.4
-1081	8A	8	17.5	19.9
-1071	7A	7	15.0	17.4
-1061	6A	6	12.5	14.9
-1051	5A	5	10.0	12.4
-1041	4A	4	7.5	9.9
-1031	3A	3	5.0	7.4
22-03-1021	AE-3022 -2A	2	2.5	4.9
PART No.	ENG. No.	No OF Ckts.	DIM. A	DIM. B

ADD NOTE 5 EC NO: E2007-0275 DRWN:DCARTON 2006/10/13 CHKD: 2006/10/16 APPR:EOHANY 2006/10/17	QUALITY SYMBOLS ▽=0 ▽=0	GENERAL TOLERANCES (UNLESS SPECIFIED) <table border="1"> <tr> <th></th> <th>mm</th> <th>INCH</th> </tr> <tr> <td>4 PLACES</td> <td>±---</td> <td>±---</td> </tr> <tr> <td>3 PLACES</td> <td>±---</td> <td>±---</td> </tr> <tr> <td>2 PLACES</td> <td>±0.10</td> <td>±---</td> </tr> <tr> <td>1 PLACE</td> <td>±0.2</td> <td>±---</td> </tr> </table>		mm	INCH	4 PLACES	±---	±---	3 PLACES	±---	±---	2 PLACES	±0.10	±---	1 PLACE	±0.2	±---	DIMENSION STYLE MM ONLY	SCALE 4:1	DESIGN UNITS METRIC	THIRD ANGLE PROJECTION
		mm	INCH																		
	4 PLACES	±---	±---																		
	3 PLACES	±---	±---																		
2 PLACES	±0.10	±---																			
1 PLACE	±0.2	±---																			
DRAWN BY PMOORE 1998/01/10 CHECKED BY OCOSTEL 1998/04/08 APPROVED BY MWILHITE 1998/04/08	TITLE MINI-KON WAFER 2.5 CEN ASSY	MATERIAL NO. SEE CHART	DOCUMENT NO. SDAE-3022-NA-*	SHEET NO. 1 OF 3																	
DRAFT WHERE APPLICABLE MUST REMAIN WITHIN DIMENSIONS	SIZE A3	THIS DRAWING CONTAINS INFORMATION THAT IS PROPRIETARY TO MOLEX INCORPORATED AND SHOULD NOT BE USED WITHOUT WRITTEN PERMISSION																			