

DRAWING MADE IN THIRD ANGLE PROJECTION

PART NUMBER	REV	FIRST USED	MACHINE REFERENCE	FEED TYPE
566408-1	A	356462-2	G-SPLICE TERM	AIR FEED
566408-2	C	2161300-1	5K CE&GII THRU SPLICE	AIR FEED
7-566408-7	A	356462-2	SPARE PARTS KIT	-
7-566408-8	C	-	CONV. KIT FOR -1 TO -2	-

566408 566408

TERMINAL NAME: AMPLIVAR™ THRU SPLICE		REF PAD LTR		CRIMPING DATA		FEED SWITCH		STRAINED WIRE	
41459		3		CRIMP HEIGHT		CRIMP SIZE		TYPE	
		3		.056 ±.002 [1.42 ±0.05mm]		B(Ø.024) & (1)20			
		3		.055 ±.002 [1.40 ±0.05mm]		A(Ø.020) & (1)20			
		3		.054 ±.002 [1.37 ±0.05mm]		B(Ø.024) & (1)22			
		3		.053 ±.002 [1.35 ±0.05mm]		A(Ø.020) & (1)22			
WIRE STRIP LENGTH		TERM APPL SPEC		FEED		APPL INSTRUCTION		SET UP GAGE	
-		114-2088		.093		408-8318 (-1) 408-127000 (-2)		-	

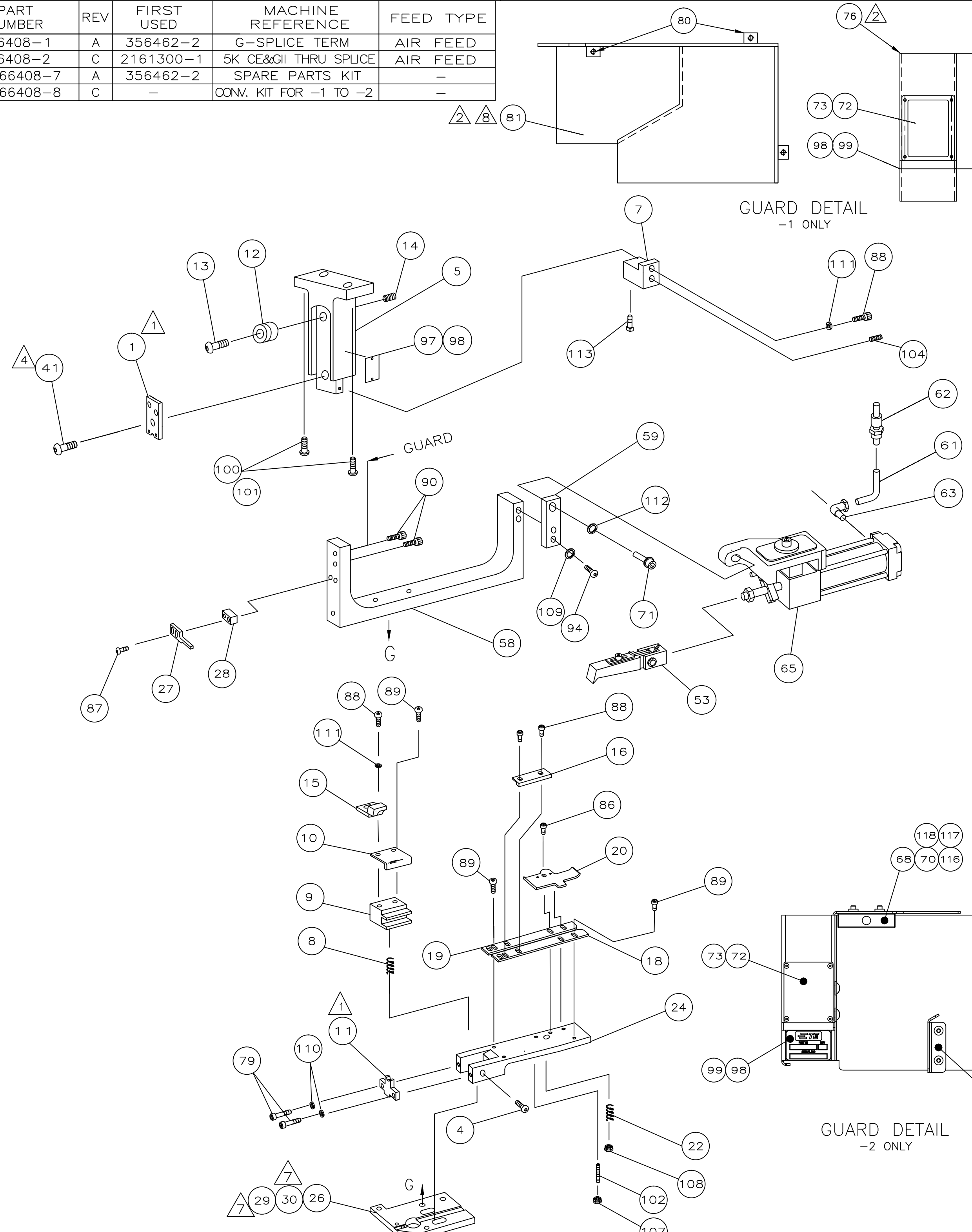

QTY	REQD	PER	ASSY	DESCRIPTION	ITEM NO		
2	-	2	-	18029-2	M4 HEX NUT	118	
2	-	2	-	18025-2	M4 LOCK WASHER	117	
2	-	2	-	18027-2	M4 FLAT WASHER	116	
1	-	1	-	408-32162	THRU SPLICE IS SHEET-GII	115	
-	-	1	1	217238-1	GENERAL INSTRUCTION PACKAGE	114	
-	-	1	1	1424328-1	SQUARE HD SCR	113	
-	-	1	1	21024-8	WASHER, LOCK (3/8)	112	
-	-	2	2	21024-3	WASHER,LOCK(NO.6)STR & SHR	111	
-	-	2	2	21024-4	WASHER,LOCK(NO.8)SHEAR BL	110	
-	-	2	2	21024-5	WASHER,LOCK(NO.10)	109	
-	-	1	1	21022-4	NUT,HEX SELF LKG(1/4-20)	108	
-	-	2	2	21018-6	NUT,HEX(8-32)DRAG	107	
-	-	1	-	408-127000	THRU SPLICE IS SHEET	106	
-	-	1	-	408-8318	THRU SPLICE IS SHEET	105	
-	-	1	1	22736-3	SCR,SKT,SET NYLON (6-32x.156)	104	
-	-	-	-	-	-	103	
-	-	2	2	5-21061-5	SCR,SKT,SET CONE PT (8-32x.88)	102	
2	-	2	-	3-18023-3	SCR, SHC (M6x50)	101	
-	-	2	-	3-18023-1	SCR, SHC (M6x30)	100	
-	-	1	1	461264-1	PLATE, IDENTIFICATION	99	
-	-	2.00	2.00	25527-6	TAPE, POLYURETHANE	98	
-	-	1	1	690701-2	PLATE, IDENTIFICATION	97	
-	-	-	-	-	-	96	
-	-	-	-	-	-	95	
-	-	2	2	3-21000-5	SCR, SHC (10-32x.50)	94	
-	-	-	-	-	-	93	
-	-	4	4	3-21002-3	SCR,BHC(1/4-20x.50)ST GD PL	92	
-	-	2	2	2-22733-8	SCR, SHC (1/4-20x.62) FEED BKT	91	
-	-	2	2	2-21002-5	SCR, BHC 10-32 X .25 LG.	90	
-	-	5	5	1-21002-6	SCR, BHC 6-32 X .25 LG.	89	
-	-	4	4	1-21000-9	SCR, SHC 6-32 X .38 LG.	88	
-	-	2	2	2-21002-3	SCR, BHC 8-32 X .62 LG.	87	
-	-	1	1	21001-7	SCR,SHC(1/4-20x1.25)DRAG & ARM	86	
-	-	-	-	-	-	85	
-	-	-	-	-	-	84	
-	-	-	-	-	-	83	
-	-	-	-	-	-	82	
-	-	-	-	-	-	81	
-	-	-	-	-	-	80	
-	-	2	2	2-21000-7	SCR,SHC(8-32X.50)ANVIL	79	
-	-	-	-	-	-	78	
-	-	-	-	-	-	77	
-	-	-	-	-	-	76	
-	-	-	-	-	-	75	
-	-	-	-	-	-	74	
-	-	4	4	21002-9	SCR, BHC (2-56X.25) GUARD WINDOW	73	
-	-	1	1	1338174-1	WINDOW, GUARD	72	
-	-	1	1	3-21001-3	SCR, SHC (3/8-16x.75) FEED ASSY	71	
-78	-77	-2	-1	U/M	PART NO	DESCRIPTION	ITEM NO
REVISION OF EACH ASSY NO (WHEN BLANK, USE DWG REVISION)							
PARTS LIST							

QTY	REQD	PER	ASSY	DESCRIPTION	ITEM NO		
2	-	2	-	1-18023-3	SCR, SHC, M4 X 16	70	
2	-	2	-	18024-6	SCR, BHC, M4 X 8	69	
1	-	1	-	2168489-1	ACTUATOR, SPARE MCI	68	
1	-	1	-	2161273-1	GUARD, END FEED INSERT	67	
1	-	1	-	2161272-2	GUARD, END FEED	66	
-	-	1	1	2-460277-2	AIR FEED ASSY	65	
-	-	-	-	-	-	64	
-	-	1	1	980285-2	ELBOW, SWIVEL (1 1/8NPT-1/4T)	63	
-	-	1	1	23238-1	QUICK DISCONNECT	62	
-	-	12.00	12.00	IN	27319-4	TUBING, POLY-FLO Ø.25	61
-	-	-	-	-	-	60	
-	-	1	1	1338207-1	BRACKET, FEED EXT	59	
-	-	1	1	1338208-1	BRACKET, FEED	58	
-	-	-	-	-	-	57	
-	-	-	-	-	-	56	
-	-	-	-	-	-	55	
-	-	-	-	-	-	54	
-	-	1	1	460680-7	FEED FINGER ASSY	53	
-	-	-	-	-	-	52	
-	-	-	-	-	-	51	
-	-	-	-	-	-	50	
-	-	-	-	-	-	49	
-	-	-	-	-	-	48	
-	-	-	-	-	-	47	
-	-	-	-	-	-	46	
-	-	-	-	-	-	45	
-	-	-	-	-	-	44	
-	-	-	-	-	-	43	
-	-	-	-	-	-	42	
-	-	1	1	7-21002-7	BOLT, CRIMPER(5/16-24x.75)	41	
-	-	-	-	-	-	40	
-	-	-	-	-	-	39	
-	-	-	-	-	-	38	
-	-	-	-	-	-	37	
-	-	-	-	-	-	36	
-	-	-	-	-	-	35	
-	-	-	-	-	-	34	
-	-	-	-	-	-	33	
-	-	-	-	-	-	32	
-	-	-	-	-	-	31	
-	-	2	2	18027-4	WASHER, FLAT M6	30	
-	-	2	2	2-18023-9	SCR,SHC M6 X 20	29	
-	-	1	1	2-690451-3	SPACER	28	
-	-	1	1	240639-1	STRIPPER	27	
-	-	1	1	1424318-1	PLATE, BASE	26	
-	-	-	-	-	-	25	
-	-	1	1	458412-3	PLATE, STRIP GUIDE	24	
-	-	-	-	-	-	23	
-	-	1	1	3-22283-0	SPRING, DRAG	22	
-	-	-	-	-	-	21	
-	-	1	1	458403-1	DRAG, STOCK	20	
-	-	1	1	458406-8	GUIDE, STRIP (REAR)	19	
-	-	1	1	458404-9	GUIDE, STRIP (FRONT)	18	
-	-	-	-	-	-	17	
-	-	1	1	1424330-2	GUIDE, TERMINAL	16	
-	-	1	1	1424334-1	REAR STRIPPER	15	
-	-	1	1	27058-2	PLUNGER, SPRING, STUBBY	14	
-	-	1	1	21004-9	SCR, SHLD .31 DIA X .50 LG.	13	
-	-	1	1	1338124-1	WHEEL, ADJUSTING	12	
-	-	1	1	1424319-8	ANVIL	11	
-	-	1	1	1424335-6	SHEAR	10	
-	-	1	1	458409-5	HOLDER, SHEAR	9	
-	-	1	1	6-22282-8	SPRING, SHEAR RETURN	8	
-	-	1	1	1424322-1	BLOCK, SHEAR DEPRESSOR	7	
-	-	-	-	-	-	6	
-	-	1	1	1338212-1	HOLDER, TOOL	5	
-	-	1	1	690461-4	SCREW, SHEAR STOP	4	
-	-	-	-	-	-	3	
-	-	-	-	-	-	2	
-	-	1	1	1-1338223-0	CRIMPER, WIRE, MODIFIED	1	
-78	-77	-2	-1	U/M	PART NO	DESCRIPTION	ITEM NO
REVISION OF EACH ASSY NO (WHEN BLANK, USE DWG REVISION)							
PARTS LIST							

- 1 RECOMMENDED SPARE PARTS.
- 2 GUARD MUST BE IN PLACE WHEN OPERATING APPLICATOR IN A BENCH MACHINE.
- 3 SEE DRAWING FOR COMPONENTS.
- 4 CRIMPER BOLT MUST BE LOOSENED TO CHANGE CRIMP HEIGHT ADJUSTING WHEEL. BE SURE TO SEAT THE CRIMPER AGAINST THE ADJUSTING WHEEL AND REALIGN THE TOOLING.
- 5 USE MANUAL PRECISION ADJUSTMENT LEVER ON G TERMINATOR TO ACHIEVE PROPER CRIMP HEIGHT.
- 6 SOLID WIRE ON BOTTOM
- 7 ITEM NOT SHOWN.
- 8 ITEM 81 IS ATTACHED TO THE G TERMINATOR GUARD DOOR WITH ITEM 80.

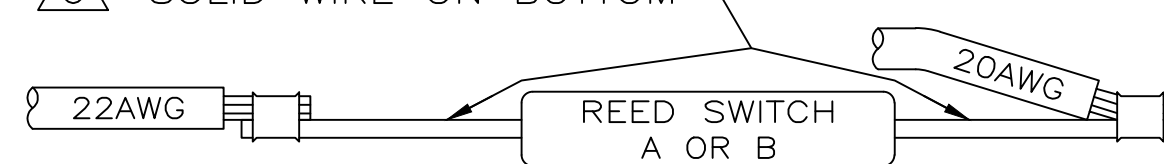

THIS DRAWING IS A CONTROLLED DOCUMENT.

THIS DRAWING IS UNCLASSIFIED  
 RELEASED FOR PUBLICATION  
 BY AMP INCORPORATED. ALL RIGHTS RESERVED.  
 MAR 27 2001  
 COPYRIGHT 2001

LOC A  
DIST 66

AMP 1756 REV 3-92 Translated 070408.044619 (YYMDD.HHMMSS) from Computer, Inc., Medusa Revision 12.2.5T

7

6

5

4

3

GAGE CODE 00779 CUSTOMER AND ASSEMBLY DRAWING 1 RESTRICTED TO

TOP

D

C

B

A