



PANDUIT PART NUMBER	WEIGHT
FROVRA6X4	0.84 LB/EACH (382g/EACH)



J NOTES:

1. SEE CURRENT CATALOG FOR ADDITIONAL PART SUFFIXES TO INDICATE COLOR AND/OR PACKAGE QUANTITY.
2. THE FIBERRUNNER 6x4 OUTSIDE VERTICAL RIGHT ANGLE FITTING IS DESIGNED WITH A MINIMUM 2" (50.8) BEND RADIUS TO PROTECT FIBER OPTIC CABLES.
3. DIMENSIONS IN PARENTHESES ARE IN METRIC.

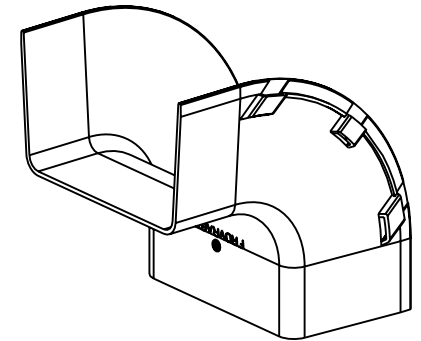
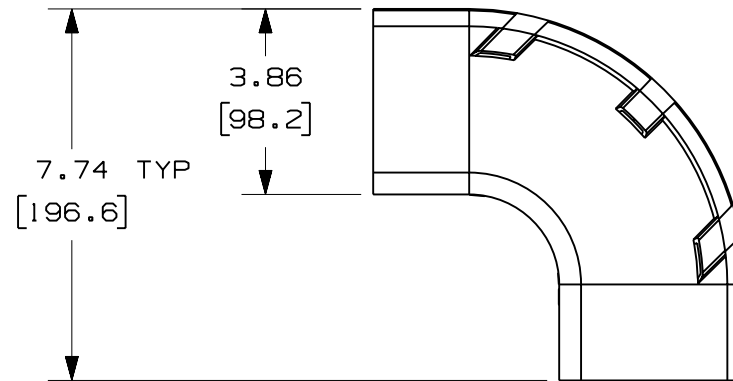
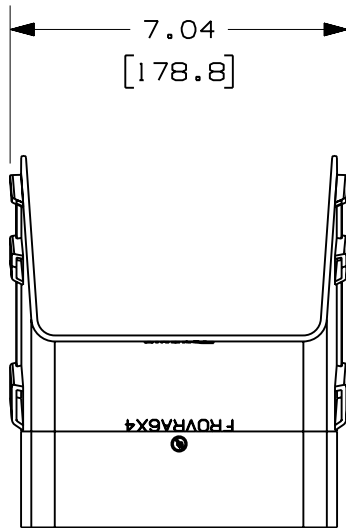

ENG. REF.: D37185E0_DC_FROVRA6X4_02.prt

CAD FILENAME/LAYERS

I FROVRA6X4.pdf

PANDUIT CORP TINLEY PARK, ILLINOIS
 FIBERRUNNER 6x4 OUTSIDE VERTICAL
 RIGHT ANGLE FITTING (FROVRA6X4)
 CUSTOMER DRAWING

UNLESS OTHERWISE SPECIFIED,
 DIMENSIONAL TOLERANCES ARE:

(.X) ± (.XXX) ±
 (.XX) ± .03 (.8) ANGLES ±

UNLESS OTHERWISE SPECIFIED,
 ALL DIMENSIONS ARE GIVEN IN
 INCHES, THIRD ANGLE PROJECTION.

DRAWN BY: REWE
 DATE: 4-28-00
 CHK'D: HIW

MAT'L:

ABS

SCALE: NONE

DRAWING NO.	DWG
37185-61	A
	SIZE

REV	DATE	BY	CHK	DESCRIPTION	ECN	R	CUST	SUP	GMBH
-	-----	---	---	K. REVISED PART WEIGHT J. REVISED GENERAL NOTES	-----	--	--		
3	7-10-06	DTP	RN	I. REVISED CAD FILENAME H. REVISED AND REDRAWN	37185-61	RN	RN		