

SW2010

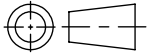

Revision level		Revision Record	Changed	Date	Approved	Date
Drawing	Part					
01	-	SEE ECN# 011861	AAC	04/12/2011	KAC	02/07/2012

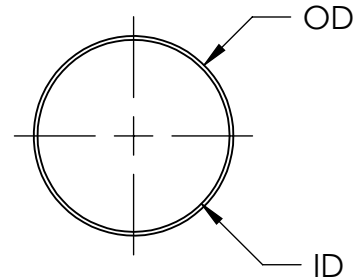
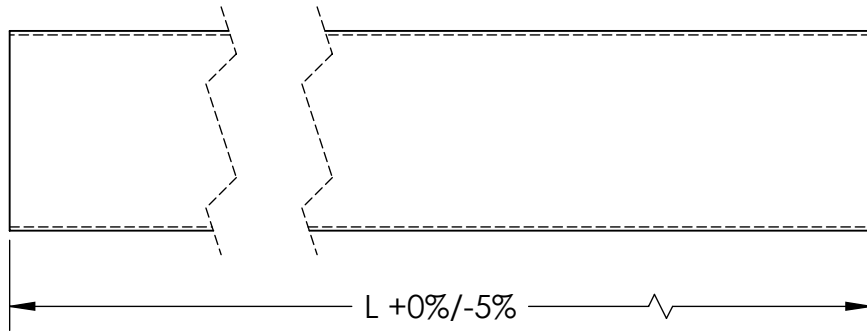
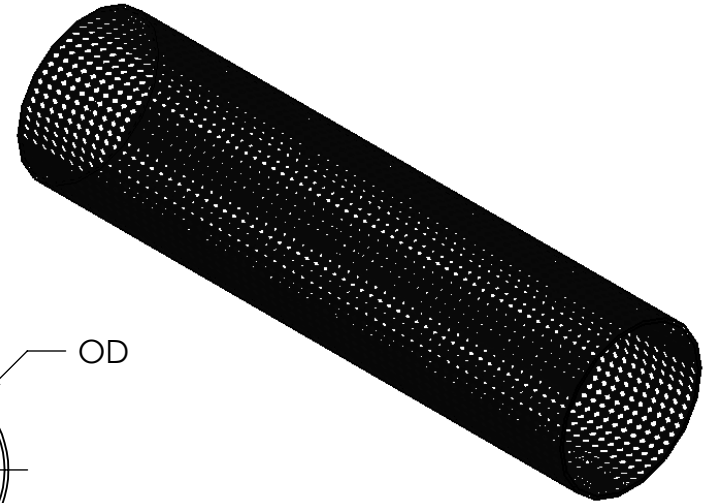

01

NOMINAL SIZE	TYPE	OD	ID	EXPANSION RANGE (FOR REF ONLY)		L (FT)
				MINIMUM	MAXIMUM	
1/8	BSPSC18	.165	.125	.125	.25	-
1/4	BSPSC14	.29	.25	.1563	.4375	100
1/2	BSPSC12	.54	.50	.25	.75	100
3/4	BSPSC34	.79	.75	.625	1.00	75
1	BSPSC10	1.04	1.00	.75	1.1875	50
1-1/4	BSPSC112	1.29	1.25	1.00	1.50	50
1-1/2	BSPSC112	1.54	1.50	1.25	2.00	50

Material
PET

Units inches
Dimension without tolerances details to:
.xxxx = ±.0005
.xxx = ±.005
.xx = ±.01
.x = ±.03
None = ±.06
∠ = ±0.5°

The copyright of this drawing is reserved by HellermannTyton. It is issued on condition that it is not reproduced, copied, or disclosed to a third party, either wholly or in part, without the consent of HellermannTyton.

Drawn AAC 04/12/2011
Approved AAC 05/16/2011

HellermannTyton
North America
Email: corp@htamericas.com
Web: www.hellermann.tyton.com

Article/Type-No SEE CHART
Title PET FRAY RESISTANT EXPANDABLE BRAIDED SLEEVING
Drawing-No 11-0337-003-CSU
Production : Phase

Scale 1:1
Project Number PRP11-0337
Format AH
Sheet 1/1