

C-152647

1st ANGLE (AMERICAN) PROJECTION

DIMENSIONS IN INCHES - DO NOT SCALE PRINT
DIMENSIONS THUS [] IN MM.

INSULATION COLOUR BROWN.

**SUPERSEDED BY
1577621-1**

.031 TONGUE THICKNESS.
[0.79]

.281 DIA.
[7.14]

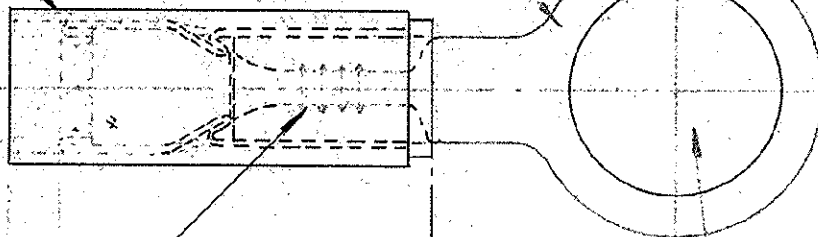

FOR INSULATION DIA.

.035 - .075
[0.89 - 1.90]

SERRATIONS

.031 MIN.
[0.79]

.242 MIN.
[6.15]

.640 MAX.
[16.26]

.787 MAX.
[19.99]

.1975±.003 DIA.
[5.008]

FOR #10 STUD.

**ENGINEERING
OFFICE
MASTER**

AIRCRAFT MARINE PRODUCTS
(GREAT BRITAIN) LTD 19

CUSTOMER COPY
REFERENCE ONLY

MATERIAL AND FINISH

COPPER -
ANNEALED,
NICKEL PLATED

**Tyco
Electronics**

Tyco Electronics Corporation
Harrisburg, PA 17105-3608

CLASS STRATOTHERM P.I.D.G.

F ECO-11-000572 HMR DR 25JAN11

WIRE RANGE - INSULATION
24-22

TYPE RING TONGUE

LTR REVISION RECORD DR CHK DATE

TOLERANCE EXCEPT AS NOTED
± .015 [0.38] ± 1°

SCALE

LOC

NO

REV

DR *Wells 2/10/69* DE

NAME

CHK *Pat 27.1.69* APP *Walmsley 25/7/70*

WIRE TERMINAL ASSY.