

DRAWING MADE IN THIRD ANGLE PROJECTION

1339690 1339690

/home/us016926/DMIECmod

PART NUMBER	REV	FIRST USED	TERMINATOR	FEED TYPE	DESCRIPTION
1339690-1	B	-	BENCH & LEADMAKER	MECH POST FEED	HD-I APPLICATOR
7-1339690-1	B	-	BENCH & LEADMAKER	MECH POST FEED	-1 AND SPARE PARTS
7-1339690-7	B	-	-	-	SPARE PARTS KIT

### CRIMP DATA AMP TERMINAL AMP CRIMP SPECS

TERMINAL NAME: CLIP 8MM (GAMME 2) RECEPTACLE

CRIMP	SIZE	TYPE	RANGE
WIRE	3.99 [1.157 IN]	F	3.00mm <sup>2</sup> - 6.00mm <sup>2</sup>
INSUL	5.49 [1.216 IN]	F	3.20-4.40 [1.26-.173 IN]

WIRE STRIP LENGTH: 6.00-6.80 [1.236-.268 IN]      APPL INSTRUCTION: 408-8323

TERMINAL	C1544141 / PRONER DRG. 10225	FEED	29.00 [1.142 IN]
----------	------------------------------	------	------------------

### TERMINALS APPLIED

TERMINAL	REV	FEED	DESCRIPTION
1544141	-	-	-
-	-	-	-
-	-	-	-
-	-	-	-
-	-	-	-
-	-	-	-
-	-	-	-
-	-	-	-
-	-	-	-
-	-	-	-

WIRE SIZE mm <sup>2</sup> AWG	CRIMP HEIGHT	PIN PN AND LENGTH [IN]
5.00mm <sup>2</sup>	2.95 ± 0.05 [1.116 ± 0.002 IN]	3-354779-2 [1.3150]
3.00mm <sup>2</sup>	2.60 ± 0.05 [1.102 ± 0.002 IN]	6-354779-0 [1.3290]

THIS DRAWING IS A CONTROLLED DOCUMENT.

LAYOUT L1339690 SET UP GAGE 458638-3

RELEASER FOR PUBLICATION BY AMP INCORPORATED. ALL RIGHTS RESERVED.

- RECOMMENDED SPARE PARTS.
- 2. GREASE RAM, CAM, CAM FOLLOWER AND FEED ROD LIGHTLY.
- 3. LUBRICATE DAILY PER THE APPLICATOR INSTRUCTION SHEET SUPPLIED WITH THE APPLICATOR.
- 4. CERTAIN TERMINALS REQUIRE LUBRICATION. REFER TO THE APPLICATOR INSTRUCTION SHEET FOR MORE INFORMATION.
- 5. WIRE RANGE SHOWN IS THAT OF THE TERMINAL.
- 6. CUT TO LENGTH AT ASSEMBLY.
- 7. SEE C1544141 / PRONER DRG. 10225 FOR SPECIFIC WIRE DETAILS.
- 8. TENSILE VALUES COMPLY WITH IEC 60352-2 AND PSA STANDARD BS217050 AND NOT TO THAT SHOWN ON PRONER DRG. 10225.
- 9. INSULATION RANGE SHOWN IS THAT OF THE APPLICATOR. INSULATION BARREL CRIMP HEIGHTS MAY NOT MEET WITH SIZES SHOWN ON PRONER DRG. 10225 AND MUST BE < 8.00MM TO FIT HOUSING 8.2MM HIGH.

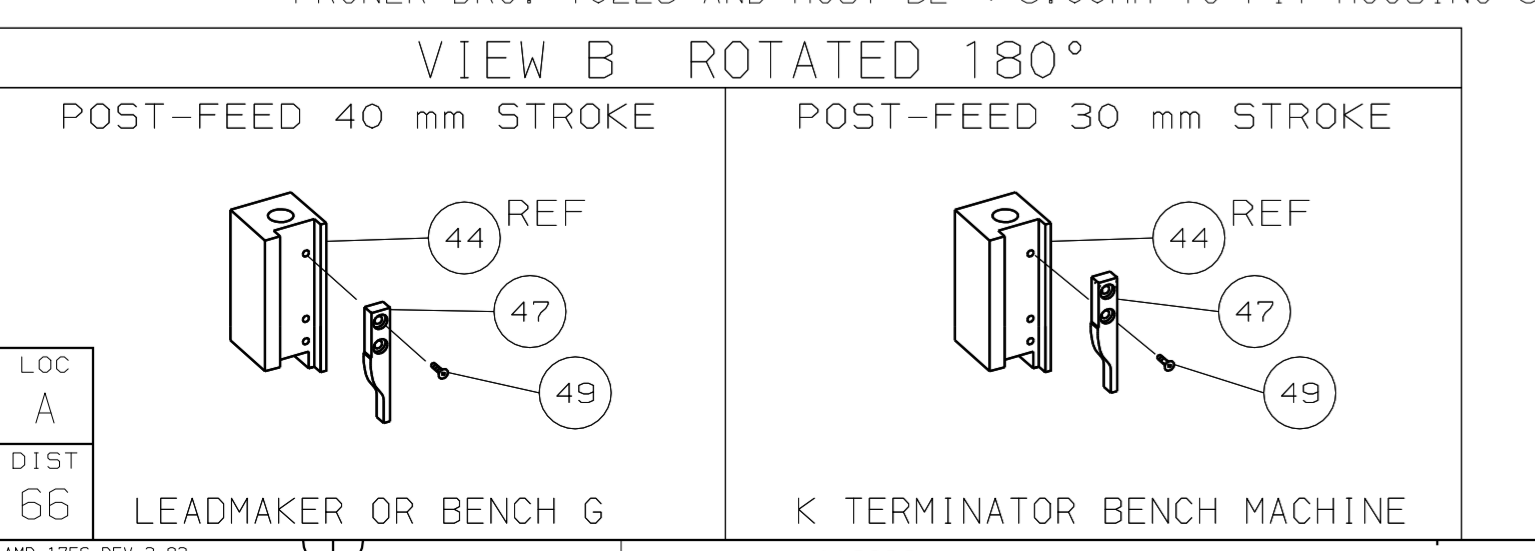
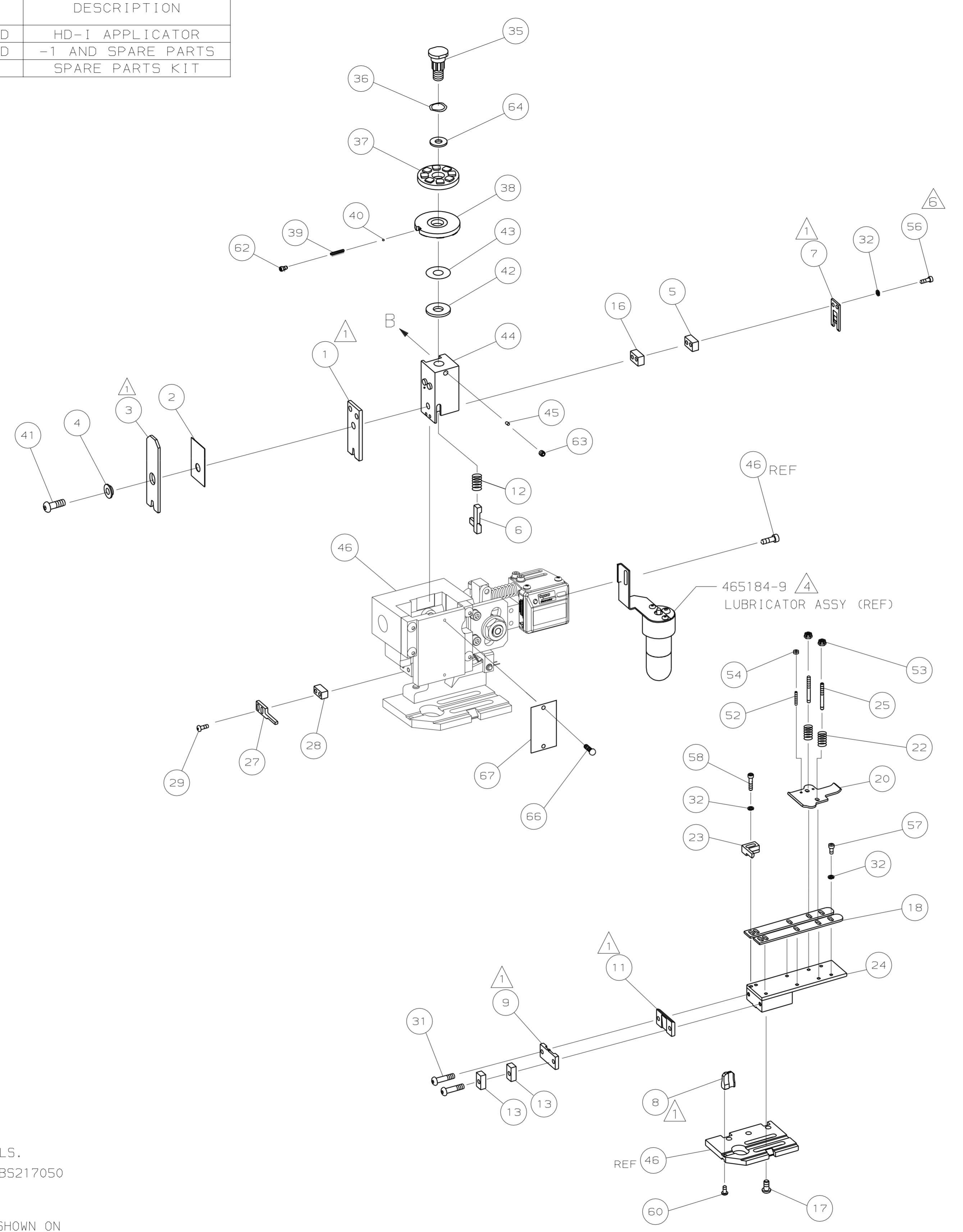

6

11

1

1

1

1

1

1

1

1

QTY	REV	DESCRIPTION	ITEM NO		
-	1	1339690	PRINT, APPLICATOR LOG SHEET	73	
-	1	1338705-2	DOCUMENTATION PACKAGE	72	
				71	
				70	
				68	
				68	
-	1	461264-1	PLATE, IDENTIFICATION	67	
-	2	21017-2	SCR,DRIVE (#2X.19) ID PLATE	66	
				65	
-	1	986950-1	WASHER, FLAT PRECISION	64	
-	1	3-18031-0	SCR,SKT SET (M6X6)RAM	63	
-	1	18023-9	SCR,SKT CAP (M4X6)CP DSC	62	
				61	
-	1	18024-7	SCR,BHC (M4X10)ANVIL	60	
				59	
-	2	2	1-18023-4	SCR,SHC (M4X20)HOLD DOWN	58
-	5	5	1-18023-0	SCR,SHC (M4X8)STRIP GUIDE	57
-	2	2	1-18023-4	SCR,SHC (M4X20)SLUG BLADE	56
				55	
-	2	2	18029-1	NUT, HEX (M3) DRAG	54
-	2	2	986965-1	NUT, HEX SL (M4) DRAG STUD	53
-	2	2	2-18032-2	SCR,SKT SET (M3X10)DRAG	52
				51	
				50	
-	1	1	18024-3	SCR,BHC (M3X10)CAM	49
				48	
-	1	1	1338676-1	CAM, POST-FEED 30 & 40 mm ST	47
-	1	1	1338662-2	APPLICATOR, BASIC (SUBASSY)	46
-	1	1	690191-1	PLUG, NYLON	45
-	1	1	1320998-1	RAM	44
-	1	1	690125-1	WASHER, LAMINATED	43
-	1	1	690124-1	WASHER, RAM	42
-	1	1	2-18024-6	SCREW,BHC (M8X25) CRIMPER	41
-	1	1	23241-1	BALL, STEEL	40
-	1	1	2-22278-7	SPRING, COMPRESSION	39
-	1	1	1320922-1	DISC, INSULATION	38
-	1	1	354777-1	WIRE DISC, PLASTIC	37
-	1	1	22480-5	WASHER, SPRING	36
-	1	1	690212-1	POST, RAM	35
				34	
				33	
-	9	9	18025-2	WASHER, LOCK (M4) SHEAR BL	32
-	2	2	4-18024-7	SCR,BHC (M4X25)SHEAR PL	31
				30	
-	2	2	18024-8	SCR,BHC (M4X12)STRIPPER	29
-	1	1	3-690451-7	SPACER, STRIPPER	28
-	1	1	690455-7	STRIPPER	27
				26	
-	2	2	1320906-1	DRAG, STUD	25
-	1	1	2-1320995-3	PLATE, STRIP GUIDE	24
-	1	1	240825-5	PLATE, STRIP HOLD DOWN	23
-	2	2	3-22281-6	SPRING, DRAG	22
				21	
-	1	1	1338665-1	DRAG, STOCK	20
				19	
-	2	2	1338663-8	GUIDE, LOWER STRIP	18
-	4	4	1-18024-8	SCR,BHC (M6X12)STRIP GD PL	17
-	1	1	1338708-1	SPACER, SLUG BLADE	16
				15	
				14	
-	2	2	2-690481-0	SPACER, HOLD DOWN	13
-	1	1	23846-1	SPRING, HOLD DOWN	12
1	1	1	240833-2	PLATE, REAR SHEAR	11
				10	
				9	
1	1	1	3-690495-7	PLATE, FRONT SHEAR	8
1	2	1	1-1333226-0	ANVIL	7
1	1	1	3-690474-0	BLADE, SLUG	6
				5	
				4	
				3	
1	2	1	1-1633471-0	CRIMPER, INSULATION	2
				1	
1	2	1	1-455888-5	SPACER, CRIMPER	1
				1	
				1	

PART NO	REVISION OF EACH ASSY NO (WHEN BLANK, USE DWG REVISION)	DESCRIPTION	ITEM NO
-77	-71	-1	

DIMENSIONS: mm [INCHES]		MATL	HT TR	FIN
DO NOT SCALE PRINT. TOLERANCES UNLESS OTHERWISE SPECIFIED.				
DR	26JAN06	APP	26JAN06	
L.L.OFTHOUSE	M.CLIFFORD			
CHK	REL	25MAY06		
		L.L.OFTHOUSE		
NAME	END FEED HD-I APPLICATOR			MACHINE REF
SCALE	1339690			HD-I APPL
DWG NO	1339690			SHEET 1 OF 1
REV	1			B

00779 CUSTOMER AND ASSEMBLY DRAWING

AMP 1756 REV 3-92 13-JUN-06 13:40:12 us016926