

Core **ER28/14/11**

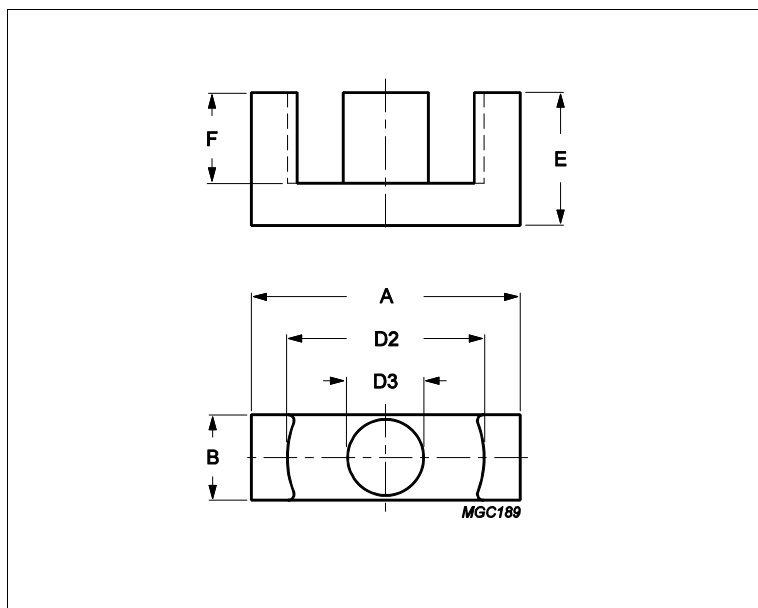

Effective parameters			
	Parameter	Value	Unit
$\Sigma(I/A)$	core factor (C1)	0.786	mm ⁻¹
Ve	effective volume	5260	mm ³
Le	effective length	64	mm
Ae	effective area	81.4	mm ²
Amin	minimum area	77	mm ²
m	ER28/14/11	≈ 14	g/pcs

Dimensions for product: ER28/14/11

	Nom	Tol +	Tol -	Max	Min	Unit
A	28.55	0.55	0.55	29.10	28.00	mm
B	11.40	0.35	0.35	11.75	11.05	mm
D2	21.75	0.50	0.50	22.25	21.25	mm
D3	9.90	0.25	0.25	10.15	9.65	mm
E	14.00	0.20	0.20	14.20	13.80	mm
F	9.75	0.40	0.40	10.15	9.35	mm

Inductance factor

Material	Value	Tol +	Tol -	Unit
3C94	3100	25%	25%	nH/turns ²

Power loss: 3C94

Measuring conditions			Max	Unit
100 kHz	200 mT	100 °C	2.600	W/set

Bsat

Measuring conditions			Material	Min	Unit
25 kHz	250 A/m	100 °C	3C94	320	mT