

This document is the property of Amphenol Corporation and is delivered on the express condition that it is not to be disclosed, reproduced or used, in whole or in part, for manufacture or sale by anyone other than Amphenol Corporation without its prior consent, & that no right is granted to disclose or to use any information in this document.

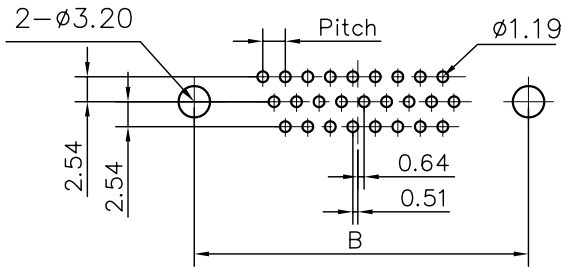
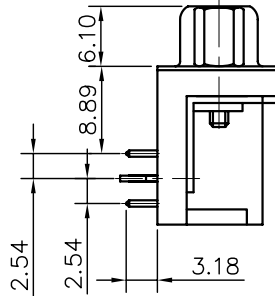
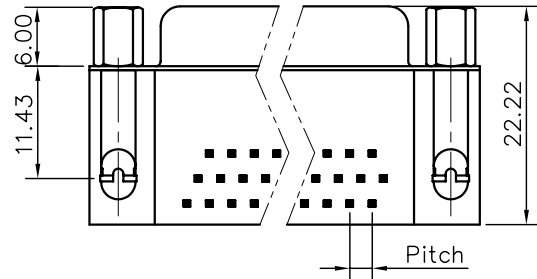
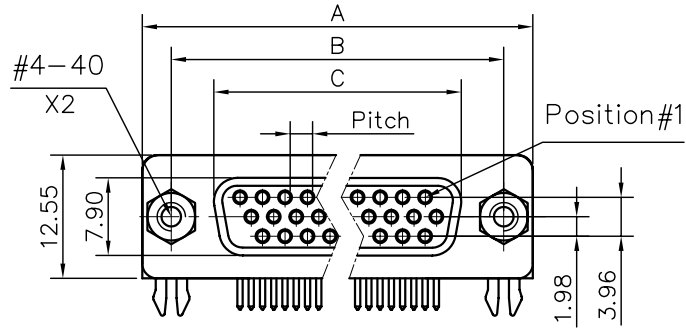

RECOMMENDED P.C.B LAYOUT
(thickness 1.6mm)

Customer drawing

DIM.S				
	SHELL	A	B	C
15	30.84	24.99	16.26	2.29
26	39.24	33.32	24.56	2.29
44	53.04	47.04	38.30	2.29
62	69.34	63.50	54.76	2.41

REVISIONS				
SYM	ECN	DESCRIPTION	DATE	APPROVED
1			02/16/09	

D-SUB TECHNICAL DATA

SHELL : Steel 2.5um(100u") min tin over 1.25um(50u") min nickel
 BODY : Glass filled thermoplastic.
 Flame retardant to UL94 V-0 Color Black
 CONTACTS : phosphor bronze
 0.76um(30u") min gold over 1.25um(50u") min nickel on the mating area
 100u" min matte tin over 50u" min Nickel on the other area
 SCREWLOCK : Brass,100u" min tin over 50u" min nickel
 BOARDLOCK : Brass,100u" min matte tin over 50u" min nickel
 ELECTRICAL : Voltage rating : 600 V RMS at 50 Hz
 Current rating 3A.
 Insulation resistance >5000 M Ohms
 Contact resistance 20mOhms max.
 CLIMATIC : Temperature range -55 °C up to 150°C
 MARKING : Amphenol...(Series No.)
 Commercial reference
 Manufacturing date

PRODUCT CODE

L 17HT H A S 4F 4 C MT

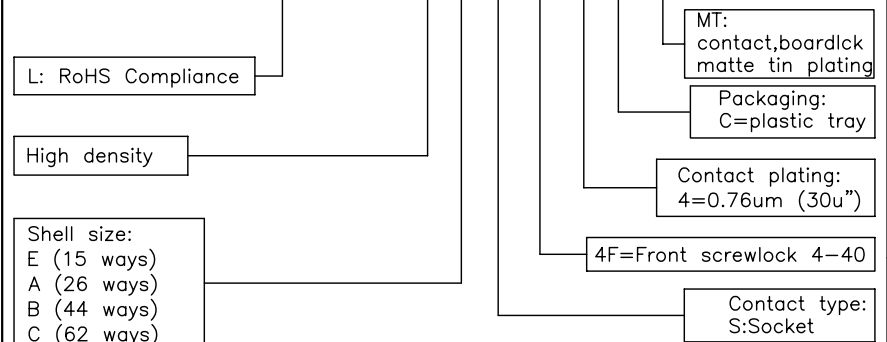

UNLESS OTHERWISE SPECIFIED TOLERANCES		APPROVAL	DATE
U.S.	METRIC	DRAWN	Ferry.ste
.X +/-	0.50	CHECKED	Lik.wang
.XX +/-	0.30	CHECKED	
.XXX +/-	0.20		
FRACTIONS +/-			
ANGLES +/-	2'		
FOR MATERIALS AND FINISHES SEE NOTES		DRAWING FILE :	
REMOVE SHARP EDGES		ANGLE OF PROJECTION	
DIMENSIONS			
U.S.	INCHES		
METRIC	MM		

Amphenol		
TITLE D-SUB connectors, HTH series		
SIZE	DRAWING NO.	REV.
A4	C L17HTHAS4F4CMT	1
SCALE	N/A	SHEET 1 OF 1