

PART NUMBER	REV	FIRST USED
567987-1	A	854040-3

TERMINAL NAME: TERMINAL, MICRO-FIT 3.0					
TYCO PN	MOLEX PN	VISIBLE PAD LTR	CRIMP DATA (MOLEX TERM & MFR SPEC)	CRIMP HEIGHT	WIRE SIZE
286975	43030-000X	A	.030 ±.002 [0.76 ±0.05mm]		26
286976	43031-000X	B	.029 ±.002 [0.74 ±0.05mm]		28
		C	.028 ±.002 [0.71 ±0.05mm]		30
		D	NOT		USED
CRIMP	SIZE	TYPE	RANGE		
WIRE	.042 [1.07mm]	F	30-26		
INSUL	.070 [1.78mm]	F	.050 MAX		
WIRE STRIP LENGTH	TERM APPL SPEC	FEED	APPL INSTRUCTION	SET UP GAGE	LAYOUT
.094-.109	NONE	.250	SEE CUSTOMER MANUAL	NONE	-

SIM TO HDM 1385711

THIS DRAWING IS A CONTROLLED DOCUMENT.

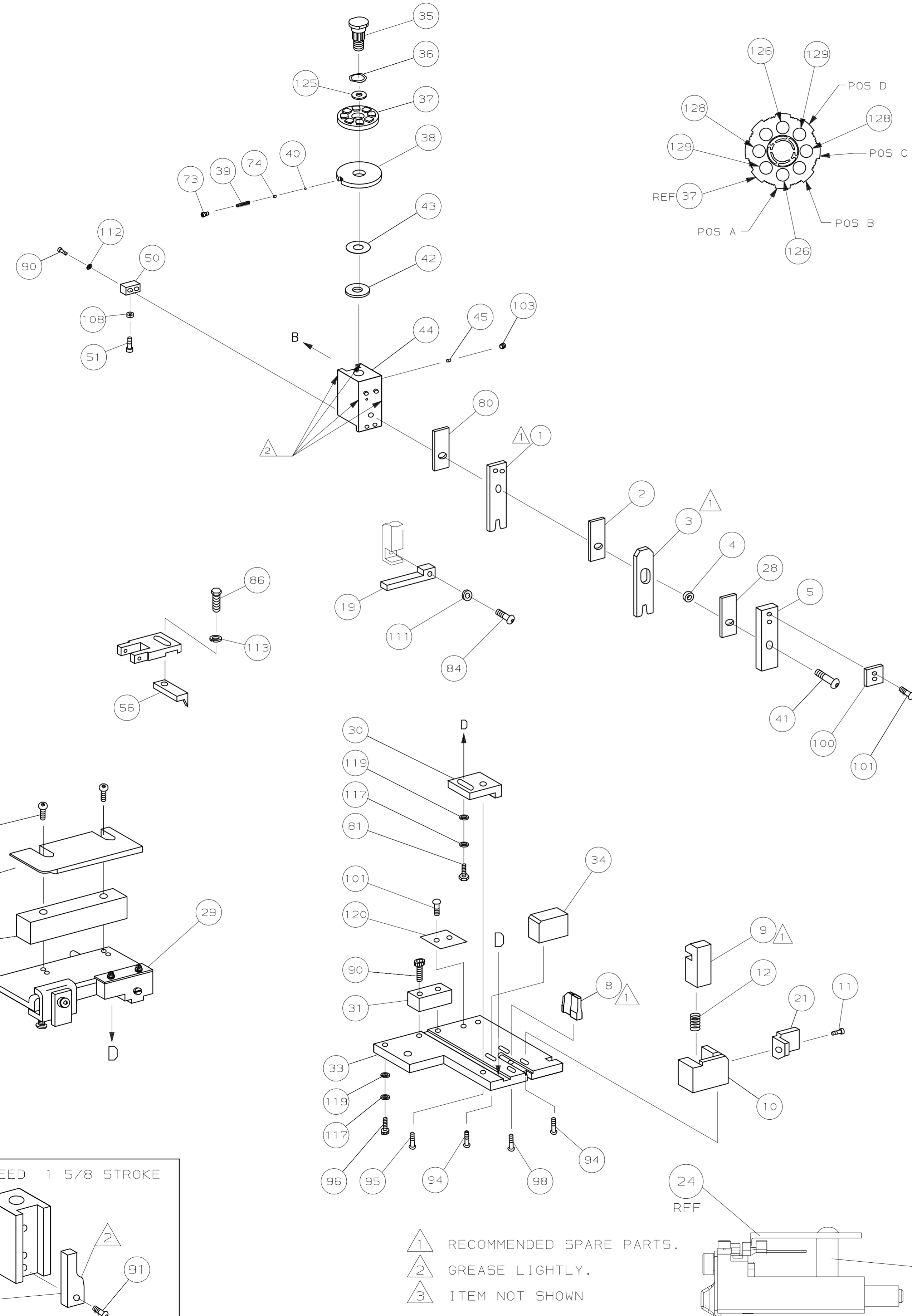

- ▲1 RECOMMENDED SPARE PARTS.
- ▲2 GREASE LIGHTLY.
- ▲3 ITEM NOT SHOWN

QTY	REV	TER	APPL	SPEC	FEED	APPL INSTRUCTION	SET UP GAGE	LAYOUT	ITEM NO
2	-	C	5-354779-2	PIN, WIRE DISC (.3250)D					129
2	-	C	5-354779-0	PIN, WIRE DISC (.3240)C					128
									127
2	-	C	5-354779-5	PIN, WIRE DISC (.3265)A					126
1	-	A	986950-1	WASHER, FLAT PRECISION					125
1	-	A	217238-3	GENERAL INSTRUCTION PACKAGE					124
									123
									122
									121
1	-	B	690701-2	PLATE, SERIAL NO.					120
2	-	A	21899-2	WASHER, FLAT (#10)S G ADJ BLK					119
									118
2	-	A	21024-5	WASHER, LOCK (#10)ADJ BLOCK					117
									116
									115
									114
REF	-	A	21024-4	WASHER, LOCK (#8)FEED FINGER					113
2	-	A	21024-4	WASHER, LOCK (#8)DEP-HOLD					112
REF	-	A	21024-4	WASHER, LOCK (#8)STRIPPER					111
									110
									109
1	-	A	21018-5	NUT, HEX (#6)HOLD DOWN					108
									107
									106
									105
1	-	A	21009-2	SCR, SKT SET (1/4-20x.25 LW)RAM					104
									103
									102
4	-	A	21017-2	SCR, DRIVE (#2x.19)ID PLATE					101
1	-	B	819347-1	PLATE, IDENTIFICATION					100
									99
1	-	A	22733-8	SCR, BHC (8-32x.38 LW)ANVIL					98
									97
1	-	A	3-21000-8	SCR, SHC (10-32x.88)MOUNTING					96
1	-	A	2-21002-7	SCR, BHC (10-32x.50)SG ADJ BLK					95
4	-	A	2-21002-2	SCR, BHC (8-32x.50)SHEAR-TERM SUP					94
2	-	A	2-21002-4	SCR, BHC (8-32x.75)R STP GDE					93
									92
1	-	A	1-21002-7	SCR, SHC (6-32x.50)CAM					91
4	-	A	2-21000-7	SCR, SHC (8-32x.50)SCR BLK					90
									89
									88
									87
REF	-	A	2-22603-0	SCR, HEX HD (8-32x.31)FEED FINGER					86
									85
REF	-	A	22733-9	SCR, BHC (8-32x.50 SL)STRIPPER					84
									83
									82
1	-	A	3-22603-1	SCR, HEX (10-32x.38)SG ADJ BL					81
1	-	C	455888-3	SPACER, CRIMPER					80
									79
									78
2	-	B	463310-9	BLADE, STRIPPING (#28)					77
									76
									75
1	-	A	690603-1	SPRING, ASSIST					74
1	-	A	23030-1	SCR, SKT CAP (6-32x.25)CP DSC					73
									72
									71

QTY	REV	TER	APPL	SPEC	FEED	APPL INSTRUCTION	SET UP GAGE	LAYOUT	ITEM NO
-1	U/M								

QTY RECD PER ASSY		PARTS LIST	
REV	DESCRIPTION	REV	DESCRIPTION

REV	DESCRIPTION	ITEM NO
		70
		69
		68
		67
		66
		65
		64
		63
		62
		61
		60
		59
		58
		57
		56
REF	B	694433-8 PAWL, FEED
		55
		54
		53
		52
1	A	811242-2 BUMPER, HOLDDOWN
1	A	690753-1 SPACER, TONKER
		49
1	A	690602-6 CAM, PRE-FEED 1.62 STROKE
		47
		46
1	A	690191-1 PLUG, NYLON
1	C	455673-1 RAM
1	A	690125-1 WASHER, LAMINATED
1	A	690124-9 WASHER, RAM
1	A	7-21002-9 BOLT, CRIMPER (5/16x1.00)
1	A	23241-6 BALL, STEEL
1	A	690170-1 SPRING, COMPRESSION
1	C	690142-5 DISC, INSULATION
1	D	354777-1 WIRE DISC, PLASTIC
1	A	22480-5 WASHER, SPRING
1	B	690212-1 POST, RAM
1	B	690786-3 SUPPORT, TERMINAL
1	C	462544-1 PLATE, BASE SPECIAL
		33
		32
1	B	462543-1 BLOCK, SCREW SPECIAL
1	B	455689-1 BLOCK, STRIP GUIDE ADJ
1	C	1633091-1 PLATE ASS'Y, STRIP GUIDE
1	C	1-455888-0 SPACER, FRONT SHEAR DEP
		28
		27
		26
		25
1	D	1320928-1 GUIDE, STRIP (REAR)
1	A	1320908-9 SPACER, STRIP GUIDE
		23
		22
1	A	463756-1 GUIDE, SCRAP
		21
		20
REF	C	462615-1 STRIPPER
		19
		18
		17
		16
		15
		14
1	A	3-22280-3 SPRING, SHEAR
1	B	1-690461-6 STOP, SHEAR (FRONT)
1	B	462548-1 HOLDER, SHEAR (FRONT) SP
1	B	462547-1 SHEAR, FLOAT (FRONT) SP
1	C	1633105-1 ANVIL
		9
		8
		7
		6
1	A	462838-8 DEPRESSOR, SHEAR (FRONT) SP
1	B	2-238011-8 SPACER, BLOCK CRIMPER
1	C	4-1213077-6 CRIMPER, INSULATION
1	C	455888-1 SPACER, CRIMPER
1	C	2-456401-5 CRIMPER, WIRE
		1

QTY	REV	TER	APPL	SPEC	FEED	APPL INSTRUCTION	SET UP GAGE	LAYOUT	ITEM NO
-1	U/M								

QTY RECD PER ASSY		PARTS LIST	
REV	DESCRIPTION	REV	DESCRIPTION

DIMENSIONS IN INCHES. DO NOT SCALE PRINT. TOLERANCES UNLESS OTHERWISE SPECIFIED:		MATL	HT TR	FIN
2 PLC DEC ±		DR	24MAY06	APP
3 PLC DEC ±		B.HIGMAN	T.ELBIN	
4 PLC DEC ±		CHK	24MAY06	REL
ANGLES ±		B.HIGMAN		
SURF TEXTURE: ✓		AMP Tyco Electronics		
REMOVE BURRS, BREAK SHARP EDGES R.015 MAX		Harrisburg, PA 17105-3808		
SCALE		NAME		MACHINE REF
	D	STRIPPER CRIMPER APPLICATOR		STRIPPER CRIMPER
	DWG NO	567987		SHEET 1 OF 1
	REV	A		REV

LOC A DIST 66

567987

D

C

B

A