

Contact assignment:

- | | |
|-----------|---------------|
| 1) brown | 7) black |
| 2) blue | 8) grey |
| 3) white | 9) red |
| 4) green | 10) violet |
| 5) pink | 11) grey-pink |
| 6) yellow | 12) red-blue |

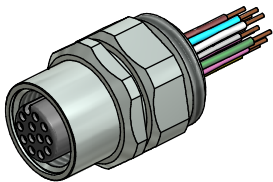

Technical specification :

Rated voltage: IEC 61076-2-101	30 V
Current rating: IEC 61076-2-101	1,5A at 40°C
Insulation resistance: IEC 60512	>=100 MΩ
Pollution degree: IEC 60664-1	3/2
Degree of protection: IEC 60529	IP 67, in mated condition
Temperature range:	-30°C ... +80°C
Mating cycles: IEC 60512-9a	>=100

Materials:

Contact:	CuZn
Contact plating:	Nickel, gold plated
Contact carrier:	PBT GF, UL 94
Sealing:	FPM
Counter nut:	CuZn, nickel plated
Socket housing:	CuZn, nickel plated
Grouting:	Polyurethane-resin, UL 94

Installation specification:

recommended torque:	1-1,2 Nm
Conec installation tool:	Torque wrench: 36-000200 Insert across flats 17: 36-000230

Part no:	Description:	Pos	Length L:	Wire:
43-01341	SAL - 12 - FKP12 - 0,5	12	0,5m	AWG 26 PVC, UL
43-xxxxx	SAL - 12 - FKP12 - ...	12	x	

DO NOT ALTER CAD DRAWING BY HAND Directive 2002/95/EC RoHS compliant	Index: c 15.02.13 MG Ä4631 Data sheet revised, technical specification changed, materials corrected	dim. in mm	title: Female socket M12x1 with wire, frontmounting, reposition							
	tolerance of wire: L ≤ 4m: L + 40mm L > 4m: L + 1%		<table border="1"> <tr> <td>date</td> <td>name</td> </tr> <tr> <td>drawn 16.10.08</td> <td>Fromm</td> </tr> <tr> <td>appd. 16.10.08</td> <td>Mankopf</td> </tr> </table>	date	name	drawn 16.10.08	Fromm	appd. 16.10.08	Mankopf	dwg no: 43K1A773
	date	name								
	drawn 16.10.08	Fromm								
appd. 16.10.08	Mankopf									
general tolerance: 0 ± 0,50mm 0,0 ± 0,25mm 0,00 ± 0,10mm		part no: see table								
<small>THIS DRAWING MAY NOT BE COPIED OR REPRODUCED IN ANY WAY, AND MAY NOT BE PASSED ON TO A THIRD PARTY WITHOUT WRITTEN PERMISSION. OWNERSHIP AND COPYRIGHT OF CONEC GmbH</small>										