



00-9175-00X-001-X06

PREFIX

SERIES

NO. OF WAYS

CODE	NO. OF WAYS
002	2
003	3

AVX CONFIDENTIAL PROPRIETARY
 The document on this print and information therewith are
PROPRIETARY to AVX and shall not be copied or disclosed
 in whole or in part without AVX's written consent.

WIRE GAUGE SIZE

CODE	ACCEPTED WIRE GAUGE	WIRE INSULATION
001	28 GAUGE SOLID OR STRANDED 26 GAUGE SOLID OR STRANDED	MIN \varnothing 0.70 MAX \varnothing 1.00

COLOUR & APPROVAL

CODE	INSULATION COLOUR	AVAILABILITY
0	BLACK	SPECIAL ORDER - NON-UL
1	WHITE	SPECIAL ORDER - NON-UL
8	BLACK	SPECIAL ORDER - UL APPROVED
9	WHITE	STANDARD - UL APPROVED

PLATING OPTION

CODE	DESCRIPTION
06	PURE TIN ALL OVER

FOR DETAILS OF CAPS REFER TO SHEET 4&5.
 FOR DETAILS OF TOOLING REFER TO SHEETS 6&7.



SHEET 1 OF 8

FORM-106-01-056-6 ISS 8

Release No.	History
102083	
102849	
03.02.2012	
102857	
24.02.2012	
102881	
21.05.2012	
102967	
01.03.2013	
103005	
19.06.2013	
103101	
13.02.2014	
103184	
31.10.2014	

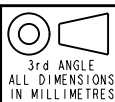

Drawn	Description	DATE
GKJ	26-28AWG IDC WIRE TO BOARD CONNECTOR	04-Apr-06
Size	Part Number	Issue
CV	00-9175-01S	12

26-28 AWG 2 WAY IDC CONNECTOR

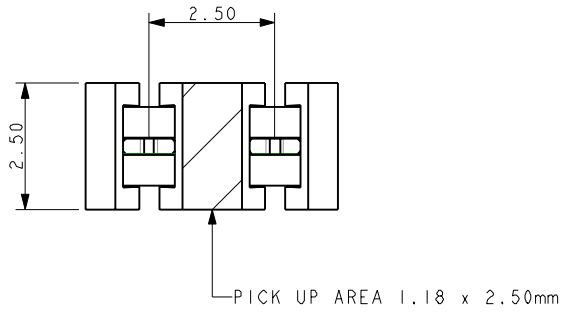

- NOTES:
- CONNECTOR FOR IDC WIRE TO BOARD CONNECTION.
 - CONTACT MATERIAL : PHOSPHORE BRONZE, INSULATION MATERIAL: HIGH TEMP NYLON 46, COLOUR REFER TO SHEET 1.
 - CONNECTOR DESIGNED TO ACCEPT 26 AND 28 GAUGE SOLID OR STRANDED WIRE.
 - ALL DIMS FOR REFERENCE UNLESS OTHERWISE STATED.
 - FOR FULL PRODUCT SPECIFICATION ON STANDARD CONNECTORS REFER TO ELCO SPEC 201-01-100, UL COMPONENTS REFER TO ELCO SPEC 201-01-100UL.
 - APPLICATION NOTES 201-01-124.
 - FOR UL PRODUCT CODES UL REFERENCE E90723 (US AND CANADA).
 - CONNECTOR OUTLINE.
 - ALL DIMENSIONS ± 0.20 UNLESS TOLERANCE SPECIFIED.

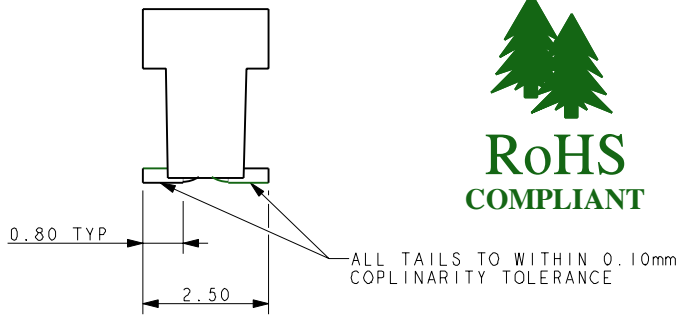
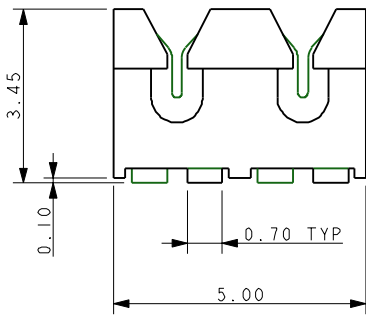

SMT PCB LAYOUT
PURE TIN PADS

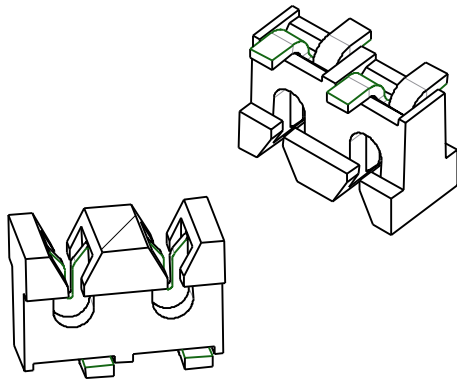

PACKING DETAILS

REEL QTY	2000
LEADER	500mm
TRAILER	500mm

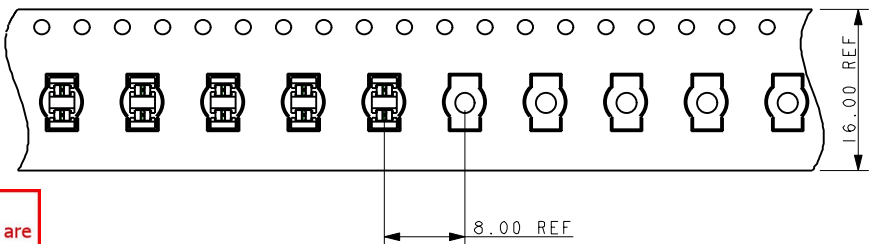
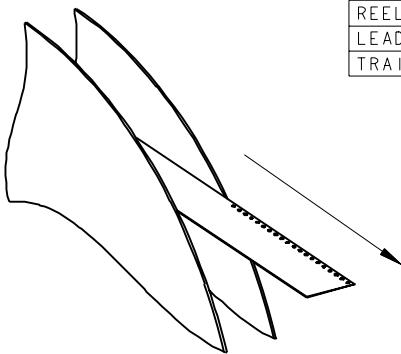
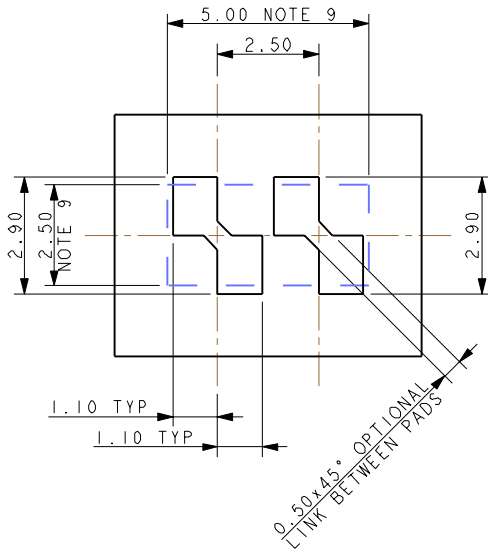

AVX CONFIDENTIAL PROPRIETARY
The document on this print and information therewith are PROPRIETARY to AVX and shall not be copied or disclosed in whole or in part without AVX's written consent.

SHEET 2 OF 8

FORM-106-01-056-6 ISS 8

Release No.	102083
History	102849
	03.02.2012
	102857
	24.02.2012
	102881
	21.05.2012
	102967
	01.03.2013
	103005
	19.06.2013
	103101
	13.02.2014
	103184
	31.10.2014

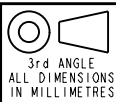

Drawn	GKJ
Size	CV

Description	26-28AWG IDC WIRE TO BOARD CONNECTOR
Part Number	00-9175-01S

DATE	04-Apr-06
Issue	12

26-28 AWG 3 WAY IDC CONNECTOR

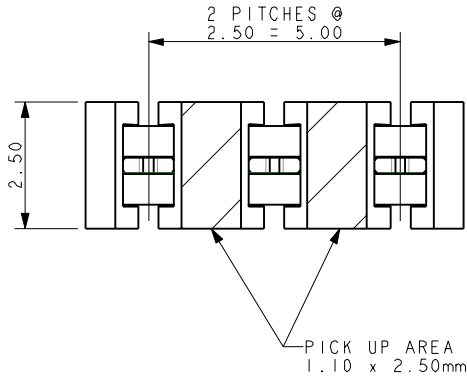

NOTES:

1. CONNECTOR FOR IDC WIRE TO BOARD CONNECTION.
2. CONTACT MATERIAL : PHOSPHORE BRONZE.
3. INSULATION MATERIAL: HIGH TEMP NYLON 46, COLOUR REFER TO SHEET 1.
4. CONNECTOR DESIGNED TO ACCEPT 26 AND 28 GAUGE SOLID OR STRANDED WIRE.
5. ALL DIMS FOR REFERENCE UNLESS OTHERWISE STATED.
6. FOR FULL PRODUCT SPECIFICATION ON STANDARD CONNECTORS REFER TO ELCO SPEC 201-01-100, UL COMPONENTS REFER TO ELCO SPEC 201-01-100UL.
7. APPLICATION NOTES 201-01-124.
8. FOR UL PRODUCT CODES UL REFERENCE E90723 (US AND CANADA).
9. CONNECTOR OUTLINE.
10. ALL DIMENSIONS ±0.20 UNLESS TOLERANCE SPECIFIED.

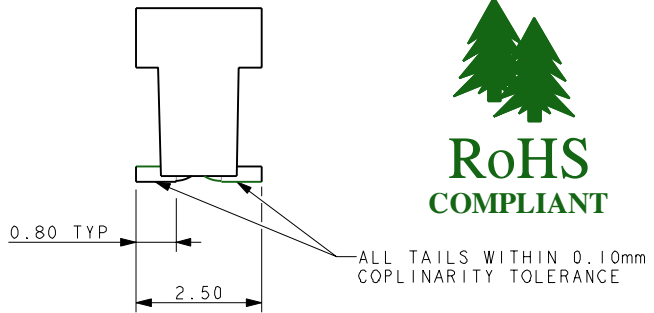
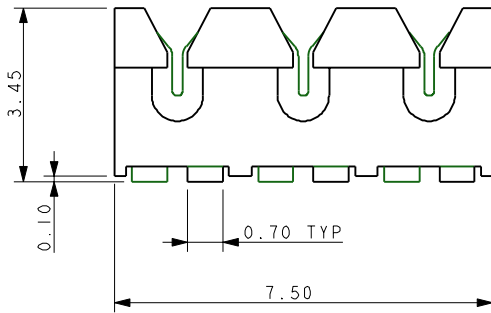

SMT PCB LAYOUT
PURE TIN PADS

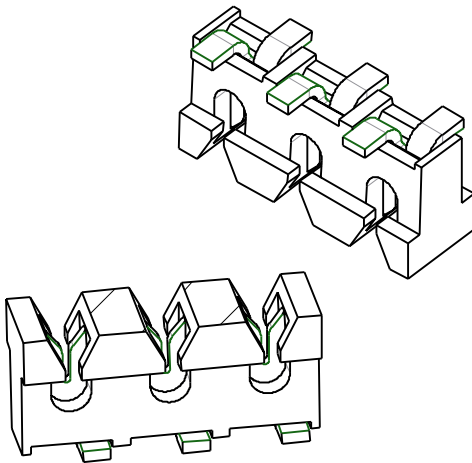

PACKING DETAILS

REEL QTY	2000
LEADER	500mm
TRAILER	500mm

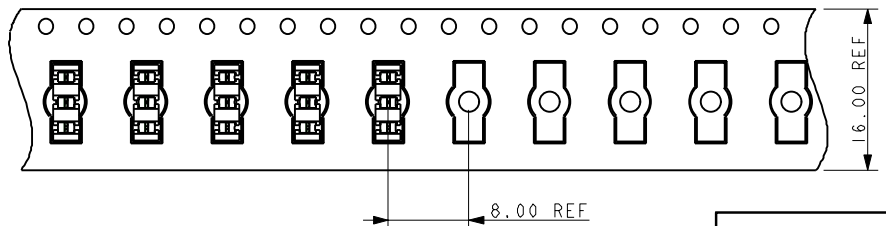
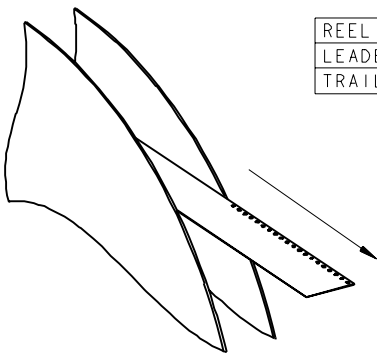
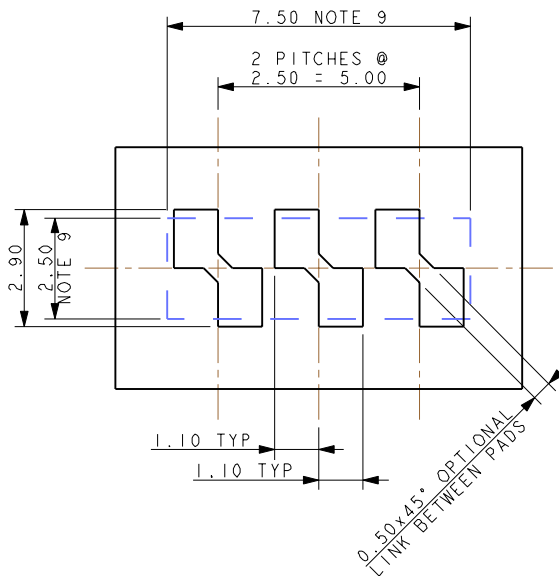

AVX CONFIDENTIAL PROPRIETARY
The document on this print and information therewith are PROPRIETARY to AVX and shall not be copied or disclosed in whole or in part without AVX's written consent.

Release No.	102083
History	102849
	03.02.2012
	102857
	24.02.2012
	102881
	21.05.2012
	102967
	01.03.2013
	103005
	19.06.2013
	103101
	13.02.2014
	103184
	31.10.2014

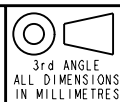

Drawn	GKJ
Size	CV

Description	26-28AWG IDC WIRE TO BOARD CONNECTOR
Part Number	00-9175-01S

DATE	04-Apr-06
Issue	12

ACCESSORY CAP - THROUGH WIRE 60-9175-00X-010-X00

CODE	NO OF WAYS
002	2
003	3

CODE	COLOUR
000	BLACK
100	WHITE

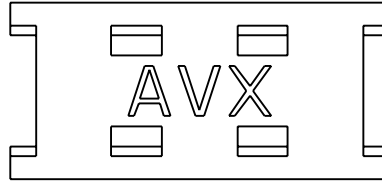

AVX CONFIDENTIAL PROPRIETARY

The document on this print and information therewith are PROPRIETARY to AVX and shall not be copied or disclosed in whole or in part without AVX's written consent.

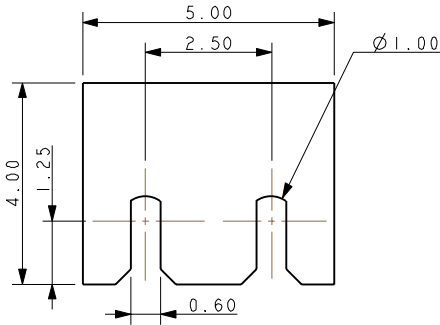
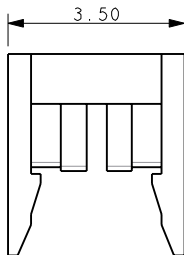
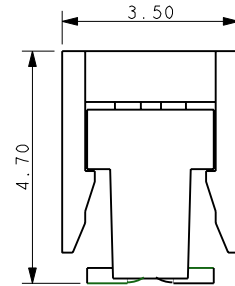
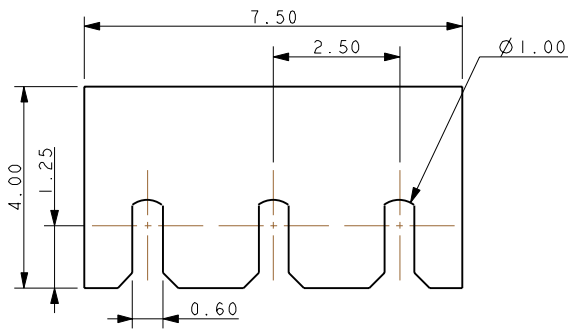
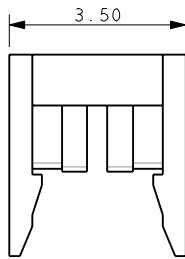

ASSEMBLED DIMENSIONS

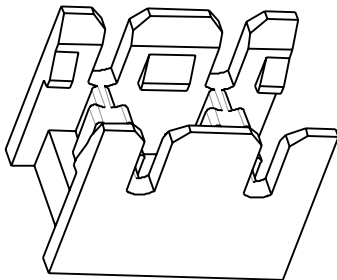

60-9175-002-010-X00

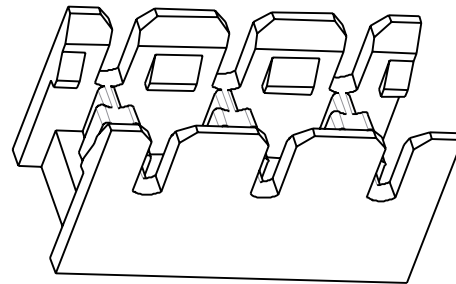

60-9175-003-010-X00

NOTES :-

1. CAP FOR IDC WIRE TO BOARD CONNECTOR, 2 & 3 WAY THROUGH WIRE.
2. THROUGH WIRE CAP CAN BE USED AT ANY POSITION ALONG A WIRE.
3. FOR USE WITH STANDARD 9175 IDC CONNECTORS,
4. CAP MATERIAL :- GLASS FILLED NYLON 46,
COLOUR OPTIONS REFER TO TABLE.
5. CAPS DESIGNED TO ACCOMODATE WIRES WITH INSULATION
UP TO 1.00mm DIAMETER.
6. GENERAL TOLERANCE ±0.20.
7. PACKED IN BAGS, 1000 PIECES PER BAG.
8. ALL DIMENSIONS ±0.20 UNLESS TOLERANCE SPECIFIED.

SHEET 4 OF 8

FORM-106-011-056-6 ISS 8

Release No.
102083
102849
03.02.2012
102857
24.02.2012
102881
21.05.2012
102967
01.03.2013
103005
19.06.2013
103101
13.02.2014
103184
31.10.2014

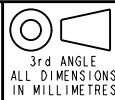

Drawn	GKJ
Size	CV

26-28AWG IDC WIRE TO BOARD CONNECTOR	Description
	Part Number 00-9175-01S

DATE 16-Sep-11
Issue 12

A

B

ACCESSORY CAP - WIRE STOP 60-9175-00X-010-X99

CODE	NO OF WAYS
002	2
003	3

CODE	COLOUR
099	BLACK
199	WHITE

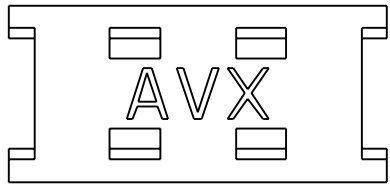

AVX CONFIDENTIAL PROPRIETARY
The document on this print and information therewith are PROPRIETARY to AVX and shall not be copied or disclosed in whole or in part without AVX's written consent.

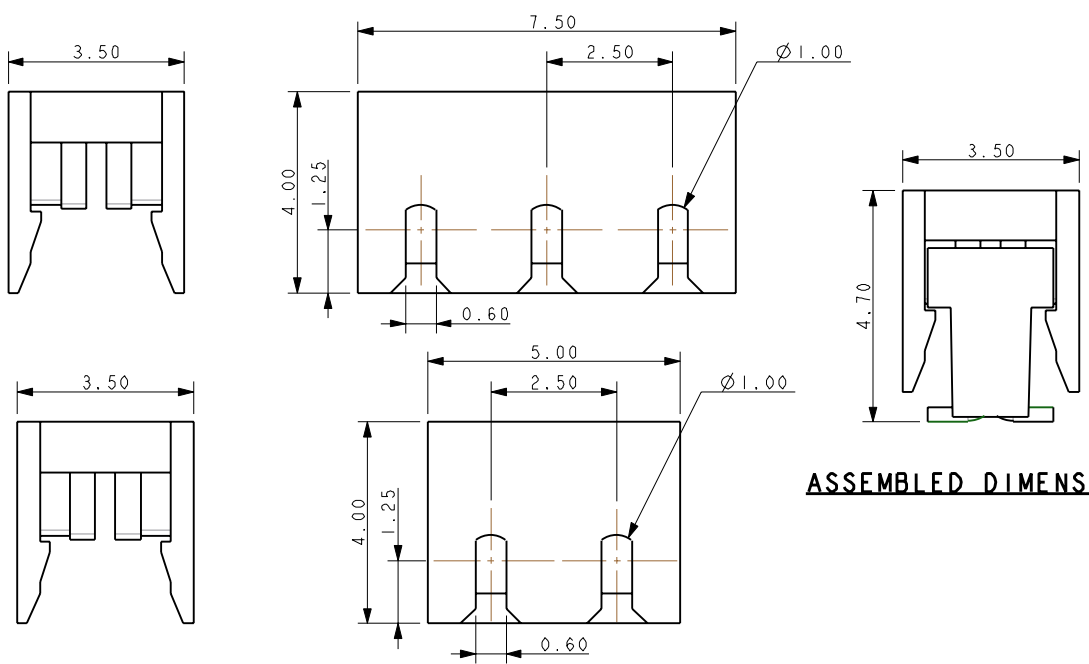

ASSEMBLED DIMENSIONS

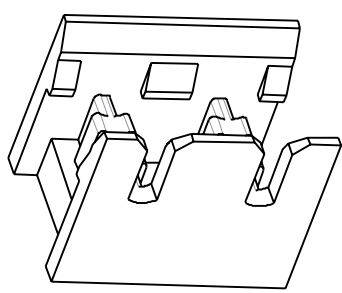

60-9175-002-010-X99

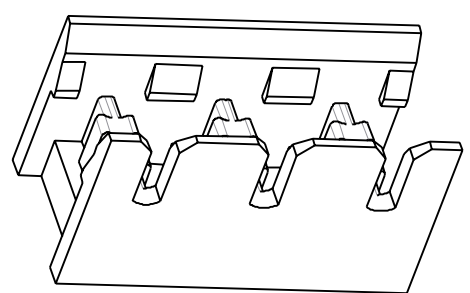

60-9175-003-010-X99

- NOTES :-**
1. CAP FOR IDC WIRE TO BOARD CONNECTOR, 2 & 3 WAY WIRE STOP.
 2. WIRE STOP CAP FOR USE AT WIRE ENDS, STOP FACE PROTECTS THE WIRE ENDS.
 3. FOR USE WITH STANDARD 9175 IDC CONNECTORS,
 4. CAP MATERIAL :- GLASS FILLED NYLON 46.
 5. COLOUR OPTIONS REFER TO TABLE.
 6. CAPS DESIGNED TO ACCOMMODATE WIRES WITH INSULATION UP TO 1.00mm DIAMETER.
 7. GENERAL TOLERANCE ±0.20.
 8. PACKED IN BAGS, 1000 PIECES PER BAG.
 9. ALL DIMENSIONS ±0.20 UNLESS TOLERANCE SPECIFIED.

FORM-106-01-056-6 ISS 8

Release No.	History
102083	
102849	
03.02.2012	
102857	
24.02.2012	
102881	
21.05.2012	
102967	
01.03.2013	
103005	
19.06.2013	
103101	
13.02.2014	
103184	
31.10.2014	

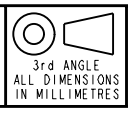

Drawn	GKJ
Size	CV

Description	26-28AWG IDC WIRE TO BOARD CONNECTOR
Part Number	00-9175-01S

DATE	16-Sep-11
Issue	12

HAND INSERTION TOOLING

SINGLE WIRE INSERTION TOOL
FOR 26/28 GAUGE WIRE

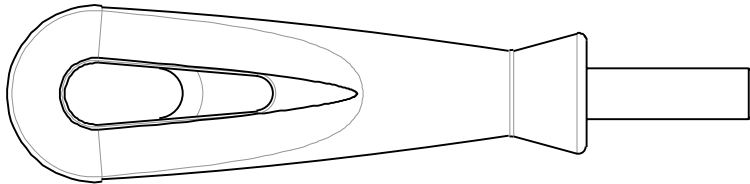

UNIVERSAL HANDLE

DETAILS	TOOL PART NUMBER
6.35 A/F HEX BIT HOLDER	06-7000-7730-01-000

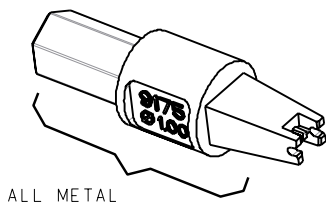

ALL METAL

HIGH PRODUCTION METAL

MAX INSULATION DIA	TOOL PART NUMBER
Ø 1.00	06-9175-7017-01-000

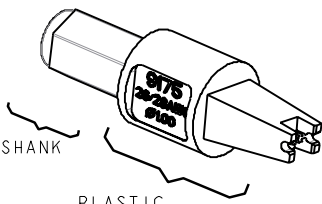

METAL SHANK

PLASTIC

MED PRODUCTION METAL/PLASTIC

MAX INSULATION DIA	TOOL PART NUMBER
Ø 1.00	06-9175-7016-01-000

AVX CONFIDENTIAL PROPRIETARY
 The document on this print and information therewith are PROPRIETARY to AVX and shall not be copied or disclosed in whole or in part without AVX's written consent.

CLEARANCE AREA ON PCB FOR HAND TOOLING

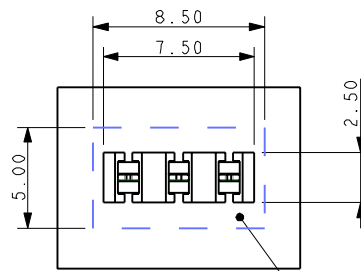
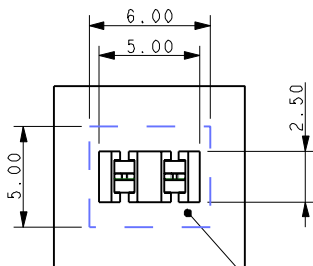

AREA TO BE KEPT CLEAR FOR TOOLING

AREA TO BE KEPT CLEAR FOR TOOLING



SHEET 6 OF 8

FORM-106-01-056-6 ISS 8

Release No.	History
102083	
102849	
03.02.2012	
102857	
24.02.2012	
102881	
21.05.2012	
102967	
01.03.2013	
103005	
19.06.2013	
103101	
13.02.2014	
103184	
31.10.2014	

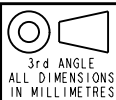

Drawn GKJ
Size CV

Description WIRE INSERTION TOOL - HAND
Part Number 00-9175-01S

DATE 04-Apr-06
Issue 12

A

B

INSERTION TOOLING

REQUIRES HAND PRESS WITH FLAT ROCK PLATES



2 WAY TOOL

TOOL NUMBER 06-9175-7017-01-002
 SKETCH SHOWS PCB RESTRICTED AREAS FOR ASSEMBLY TOOLING

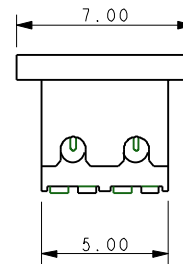
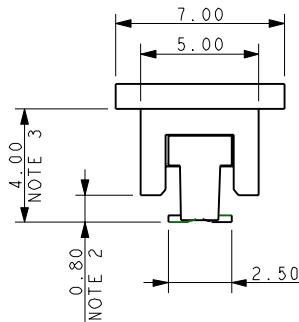
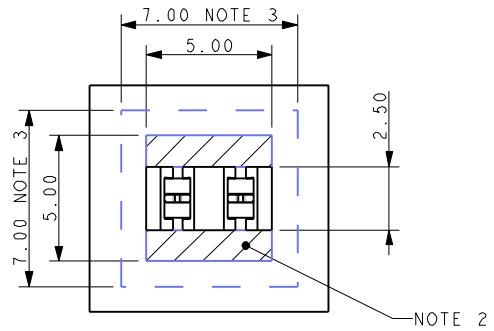
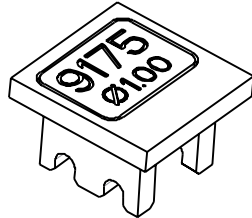

3 WAY TOOL

TOOL NUMBER 06-9175-7017-01-003
 SKETCH SHOWS PCB RESTRICTED AREAS FOR ASSEMBLY TOOLING

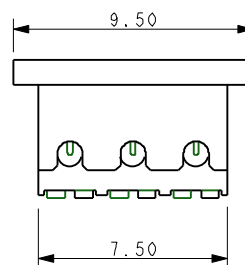
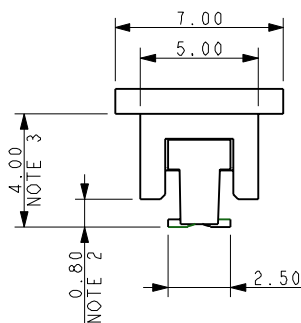
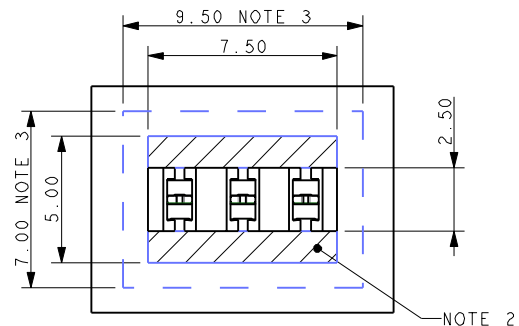
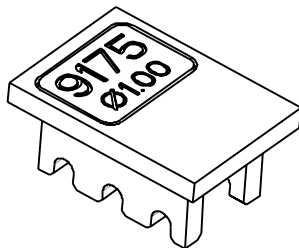

AVX CONFIDENTIAL PROPRIETARY
 The document on this print and information therewith are
 PROPRIETARY to AVX and shall not be copied or disclosed
 in whole or in part without AVX's written consent.

- NOTES :-
1. DIMENSIONS SHOWN ARE REFERENCE DIMENSIONS.
 2. MAXIMUM COMPONENT HEIGHT 0.80mm IN THIS AREA.
 3. MAXIMUM COMPONENT HEIGHT 4.00mm IN THIS AREA.
 4. THE SAME RESTRICTIONS APPLY TO ALL WIRE INSULATION DIAMETERS.

SHEET 7 OF 8

FORM-106-011-056-6 ISS 8

Release No.
History
102083
102849
03.02.2012
102857
24.02.2012
102881
21.05.2012
102967
01.03.2013
103005
19.06.2013
103101
13.02.2014
103184
31.10.2014

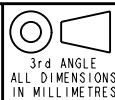

Drawn	GKJ
Size	CV

Description	WIRE INSERTION TOOL - PRESS
Part Number	00-9175-01S

DATE	15-Oct-09
Issue	12

A

B

ASSEMBLED CONNECTOR

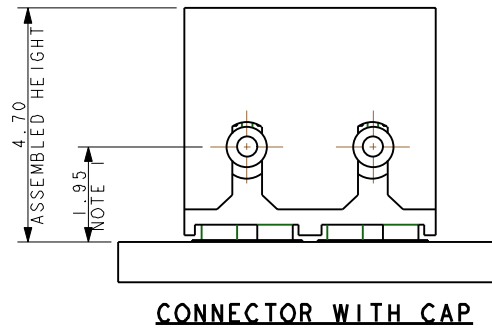
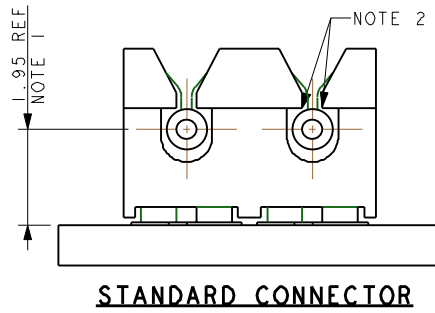

- NOTES :-
1. ASSEMBLED HEIGHTS INCLUDE A 0.10mm ALLOWANCE FOR PAD AND SOLDER THICKNESS, NO ALLOWANCE HAS BEEN MADE FOR ANY SOLDER RESIST OR OTHER FEATURES.
 2. WHEN THE WIRE IS ASSEMBLED THE INSULATION SHOULD BE TRAPPED BY THESE EDGES.

AVX CONFIDENTIAL PROPRIETARY
 The document on this print and information therewith are PROPRIETARY to AVX and shall not be copied or disclosed in whole or in part without AVX's written consent.

SHEET 8 OF 8

FORM-106-011-056-6 ISS 8

Release No.	102083
History	102849
	03.02.2012
	102857
	24.02.2012
	102881
	21.05.2012
	102967
	01.03.2013
	103005
	19.06.2013
	103101
	13.02.2014
	103184
	31.10.2014

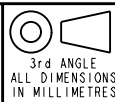

Drawn	GKJ	Description	26-28AWG IDC WIRE TO BOARD CONNECTOR	DATE	19-Jun-13
Size	CV	Part Number	00-9175-01S	Issue	12